





Office Eden Design, Genk, Belgium



Handmade in Belgium

Since 2007 we combine the imagination of the designers with our research and development, allowing in only a few years to create a range of products with timeless design, distributed from Genk, Belgium to over 50 countries world-wide.

Innovation & Quality

Artificial light is as important as sunlight, which is why Eden Design invests all its knowhow in exclusive and innovative lighting products that comply with international quality standards.

Personal project

Most of the lighting products can be customized, allowing to obtain an exclusive product that is adapted to your projects. You will thus be able to create an atmosphere, accentuate objects (clothes, paintings, ...) as you wish.

°online 8

°knick

°knick small

°in

°in small

°turn

NEW °turn plus

NEW °turn soraa

°out

NEW °udisk

NEW °odisk

°dot

NEW °dot turn

NEW °bloc 78

NEW °hide-out 90

°led line 100

NEW °oh!led 108

°sphere 116

°led on fire 134

°fool moon 140

NEW °leditbi 156

°XXXL(amp) 164

°diabolo 174

°XL(amp) 180

°i-light 192

°table cloth 198

°SO1 204

°poirot 210

°de light ful 218

°online

The power of this light source lies in its slenderness and unobtrusiveness; the simplicity of the fixtures' design makes that it can be used anywhere. An innovative and state-of-the-art magnet and contact system makes that a wide variety of led-fixtures can be easily inserted or moved.

The led-fixtures are similar in style yet each one of them has its own character and lighting quality.

Eden Design was the first to introduce this magnet system on the market. First presentation was in **2010** on the designfair Interieur Kortrijk, Belgium.

This collection won several awards, such as:

- The Best of the Best Red Dot Award (2011)
- Design Plus powered by Light & Building (2012)
- Henri van de Velde Label (2010)

Design by Bart Lens



reddot design award
best of the best 2011



DESIGN PLUS
powered by: light+building



°turn



°in.small



°dot



°knick.small

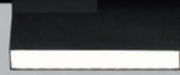

°knick

°out

°in

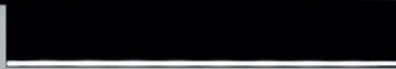
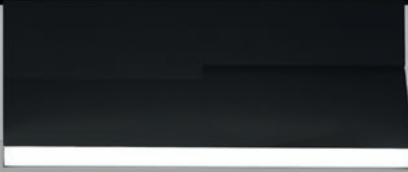







NEW

°o-disk /general lighting



NEW

°u-disk / powerful spot























°on line

25



°knick monopoint with plasterkit







*dot monopoint with plasterkit / Grey Perfection, Moscow - architect Dina Mezheva - photograph by Bogdan Vitkov







*turn / galerie Kamel Mennour, Paris - architect Pierre Yovanovitch - lighting design Dominique Liners (ETOILES)
photograph by Jean-François Jaussaud - Luxproductions











*out / Church Genk, Belgium - architect PCP Architects - photograph by Philippe van Gelooven



°online suspended track / Design Museum Gent, Belgium - photograph by Beeldpunt













o line

material aluminium coated
weight 1,75 kg/lm - 1,16 lb/feet
voltage 24Vdc
max wattage 240W on single circuit
circuits 2
dimming 1-10V / 0-10V / Dali
certifications CE  
classifications IP20 

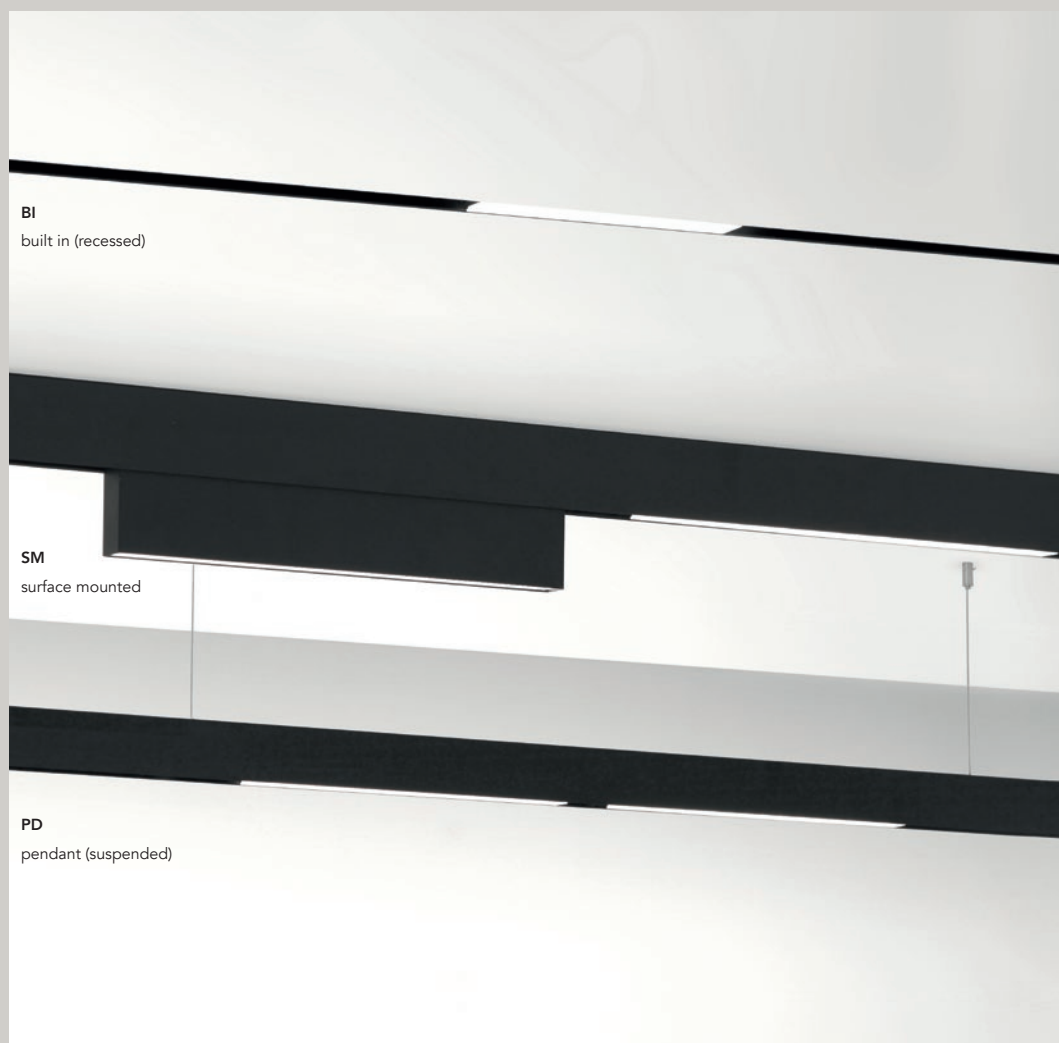
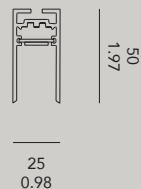

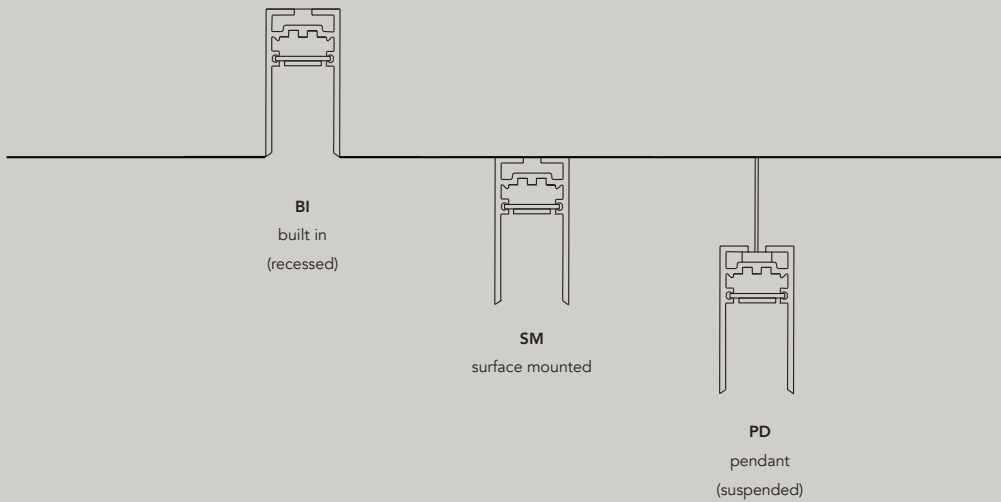

L.L.C.T

Length	4000 300 - ...	standard length in mm custom length in mm
Color body	BK WH AL	black matt ral 9011 white matt ral 9016 aluminium color ral 9006 (on request only)
Type mounting	BI SM PD	built in (recessed) surface mount pendant (suspended / standard cable of 2m included)

Brackets

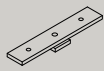

standard bracket
(included with BI)

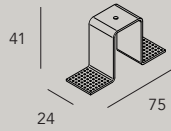

L.BI.MB
(option)

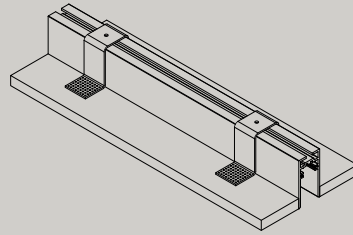
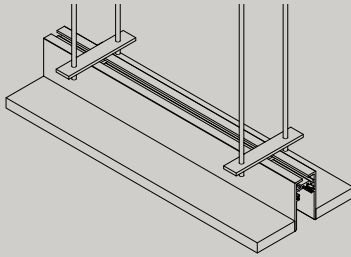

Connectors

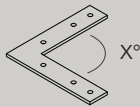

L.MC.90°
(standard)

L.MC.X°
(custom)

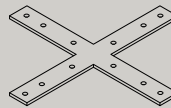

L.MC.
CROSS

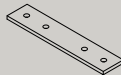
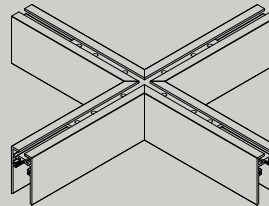
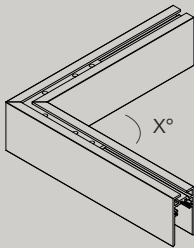

L.MC.ST



L.MC.T

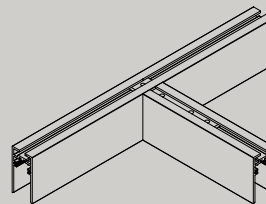
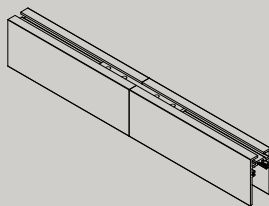

Round Corner	End Cap	Pendant Extension Cable
L.CORN.RND.WH L.CORN.RND.BK	L.EC.WH L.EC.BK L.EC.AL	PD.EC.8M

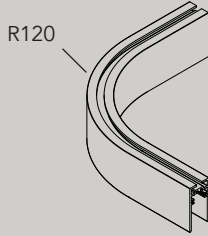

L.CP.L.C	Cover profile						
Length	<table border="0"> <tr> <td>1000</td> <td>1000 mm - 39,37 in</td> </tr> <tr> <td>2000</td> <td>2000 mm - 78,74 in</td> </tr> <tr> <td>4000</td> <td>4000 mm - 157,48 in</td> </tr> </table>	1000	1000 mm - 39,37 in	2000	2000 mm - 78,74 in	4000	4000 mm - 157,48 in
1000	1000 mm - 39,37 in						
2000	2000 mm - 78,74 in						
4000	4000 mm - 157,48 in						
Color	<table border="0"> <tr> <td>BK</td> <td>black matt ral 9011</td> </tr> <tr> <td>WH</td> <td>white matt ral 9016</td> </tr> <tr> <td>AL</td> <td>aluminium color ral 9006 (on request only)</td> </tr> </table>	BK	black matt ral 9011	WH	white matt ral 9016	AL	aluminium color ral 9006 (on request only)
BK	black matt ral 9011						
WH	white matt ral 9016						
AL	aluminium color ral 9006 (on request only)						

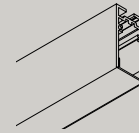

power supply ceiling box (only for surface mounted version)

PSCB.BK	color black
PSCB.WH	color white



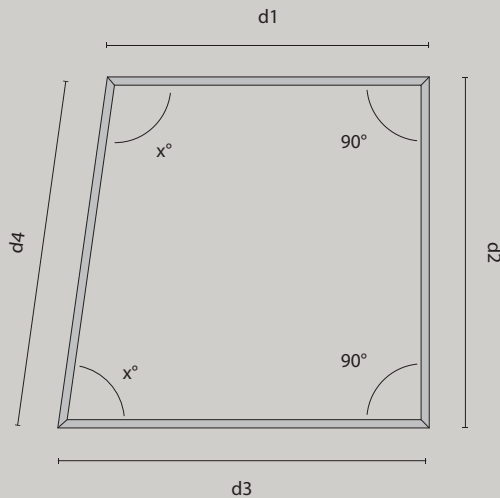

310x100x50 mm
12,20x3,93x1,96 in

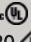

Mention the outside dimensions of the tracks and the inner corners

°knick

material aluminium coated
weight 990gr / 2.18lb
voltage 24Vdc
cri >90
wattage 16,5W
dali supported (option)
DALI DT8, tunable white
inclination 90°
certifications CE  
classifications IP20 

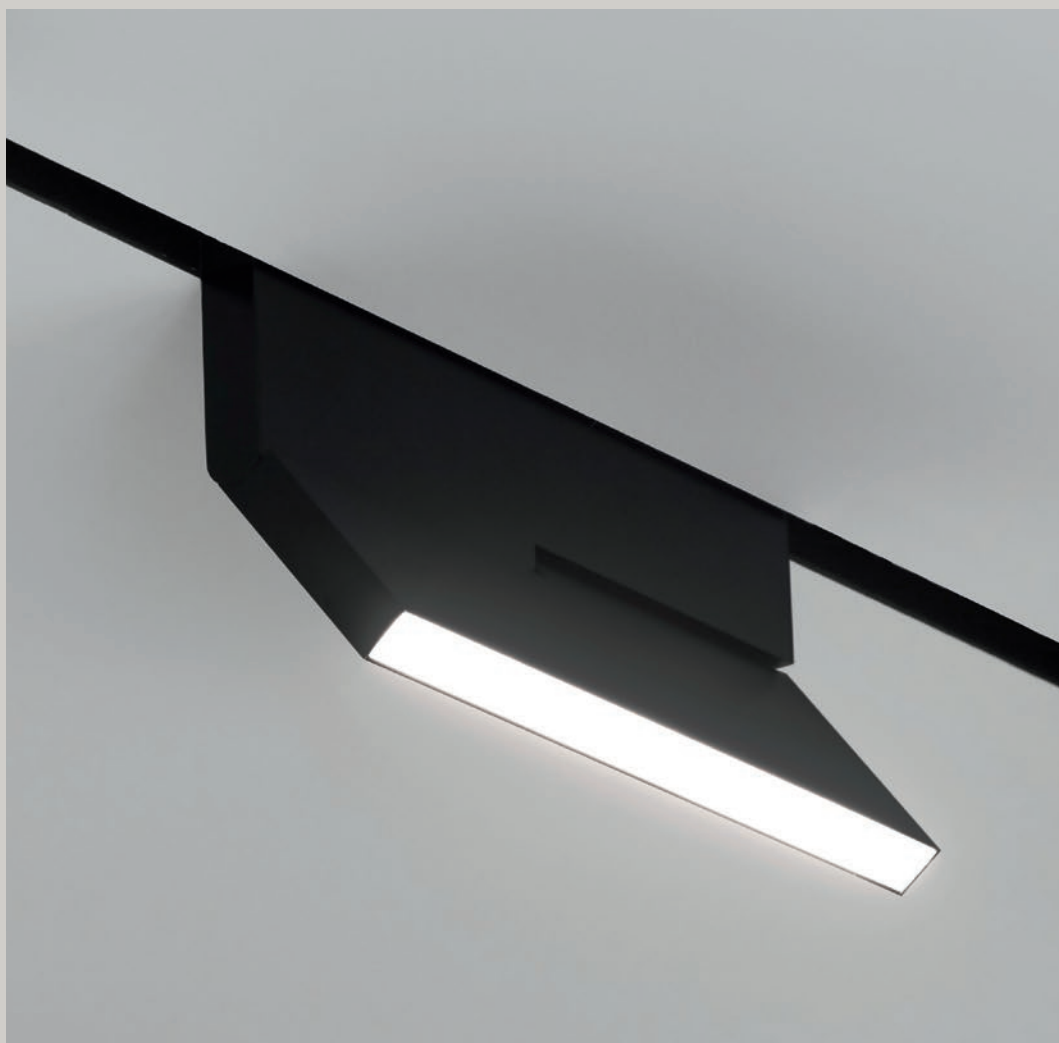
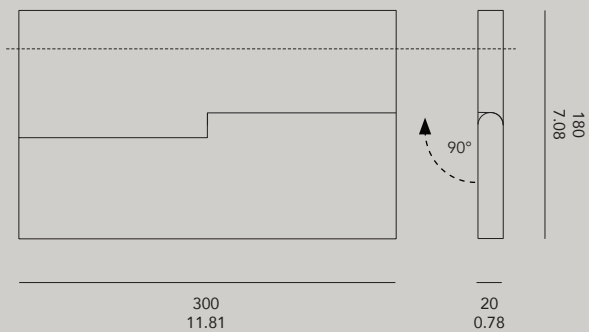

KNICK.L.C.D.V.D

Led	WW	2700K 16,5W		
	WW2	3000K 16,5W		
	NW2	4000K 16,5W		
	TW	tunable white (only with IC) 18W 2200-6500°K		
Color body	BK	black matt ral 9011		
	WH	white matt ral 9016		
	AL	aluminium color ral 9006 (on request only)		
Diffuser	FI	frosted ice diffuser (wide beam)	WW	1100 lm / 490 cd
			WW2	1100 lm / 490 cd
			NW2	1100 lm / 490 cd
			TW	
	MP	microprism diffuser (wide beam & anti-glare)	WW	1100 lm / 600 cd
			WW2	1100 lm / 600 cd
			NW2	1100 lm / 600 cd
			TW	
Version	T	track mount		
	BI	built in monopoint (plasterkit required)		
Dimming	IC	fixtures individually dimmable, controlled by DALI DT8 track overall control. dimming possible with 0/1-10V, potentiometer or DALI, on 2 circuits (see pag. 76)		
	OC			
Accessories	PL.300	monopoint plasterkit 300 mm		
	KNICK.FI	interchangeable frosted ice diffuser		
	KNICK.MP	interchangeable microprism diffuser		

°knick small

material	aluminium coated
weight	350gr / 0.77lb
voltage	24Vdc
cri	>90
wattage	9,6W
inclination	90°
dali	supported (option) DT6
certifications	CE  ENEC
classifications	IP20 

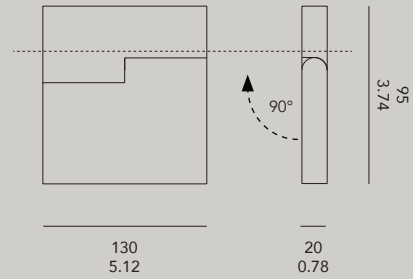

KNICK.S.L.C.D.V.D				
Led	WW	2700K 9,6W		
	WW2	3000K 9,6W		
	NW2	4000K 9,6W		
Color body	BK	black matt ral 9011		
	WH	white matt ral 9016		
	AL	aluminium color ral 9006 (on request only)		
Diffuser	FI	frosted ice diffuser (wide beam)	WW	400 lm / 500 cd
			WW2	550 lm / 800 cd
			NW2	600 lm / 855 cd
	MP	microprism diffuser (wide beam & anti-glare)	TW	
			WW	400 lm / 500 cd
			WW2	550 lm / 800 cd
	25	optic 25°	NW2	600 lm / 855 cd
			TW	
			WW	785 lm / 2940 cd
	45	optic 45°	WW2	825 lm / 3075 cd
			NW2	865 lm / 3150 cd
			WW	450 lm / 560 cd
			WW2	600 lm / 855 cd
			NW2	640 lm / 860 cd
Version	T	track mount		
	BI	built in monopoint (plasterkit required)		
Dimming	IC	fixtures individually dimmable, controlled by DALI DT6		
	OC	track overall control. dimming possible with 0/1-10V, potentiometer or DALI, on 2 circuits (see pag. 76)		
Accessories	PL.130	monopoint plasterkit 130 mm		

o'in

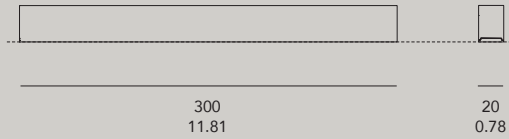

material	aluminium coated
weight	260gr / 0.57lb
voltage	24Vdc
cri	>90
wattage	16,5W
dali	supported (option) DALI DT8, tunable white
certifications	CE  
classifications	IP20 



IN.L.C.D.V.D				
Led	WW	2700K 16,5W		
	WW2	3000K 16,5W		
	NW2	4000K 16,5W		
	TW	tunable white (only with IC) 18W 2200-6500°K		
Color body	BK	black matt ral 9011		
	WH	white matt ral 9016		
	AL	aluminium color ral 9006 (on request only)		
Diffuser	FI	frosted ice diffuser (wide beam)	WW	1300 lm / 530 cd
			WW2	1300 lm / 530 cd
			NW2	1300 lm / 530 cd
			TW	
	MP	microprism diffuser (wide beam & anti-glare)	WW	1300 lm / 600 cd
			WW2	1300 lm / 600 cd
			NW2	1300 lm / 600 cd
			TW	
Version	T	track mount		
	BI	built in monopoint (plasterkit required)		
Dimming	IC	fixtures individually dimmable, controlled by DALI DT8		
	OC	track overall control. dimming possible with 0/1-10V, potentiometer or DALI, on 2 circuits (see pag. 76)		
Accessories	PL.300	monopoint plasterkit 300 mm		
	IN.FI	interchangeable frosted ice diffuser		
	IN.MP	interchangeable microprism diffuser		

°in small

material aluminium coated
weight 140gr / 0.31lb
voltage 24Vdc
cri >90
wattage 10W
dali supported (option) DT8
certifications   
classifications IP20 

	
150 5.90	20 0.78



IN.S.L.C.D.V.D				
Led	WW	2700K 10W		
	WW2	3000K 10W		
	NW2	4000K 10W		
Color body	BK	black matt ral 9011		
	WH	white matt ral 9016		
	AL	aluminium color ral 9006 (on request only)		
Diffuser	FI	frosted ice diffuser (wide beam)	WW	485 lm / 180 cd
			WW2	510 lm / 190 cd
			NW2	535 lm / 200 cd
	MP	microprism diffuser (wide beam & anti-glare)	WW	485 lm / 180 cd
			WW2	510 lm / 190 cd
			NW2	535 lm / 200 cd
Version	T	track mount		
	BI	built in monopoint (plasterkit required)		
Dimming	IC	fixtures individually dimmable, controlled by DALI DT8 track overall control. dimming possible with 0/1-10V, potentiometer or DALI, on 2 circuits (see pag. 76)		
	OC			
Accessories	PL.150	monopoint plasterkit 150 mm		
	IN.S.FI	interchangeable frosted ice diffuser		
	IN.S.MP	interchangeable microprism diffuser		

°turn

material aluminium coated
weight 380gr / 0,83lb
voltage 24Vdc
cri >90
wattage 9,6W
dali supported (option) DT6
rotation 355°
inclination 90°
certifications CE   
classifications IP20 

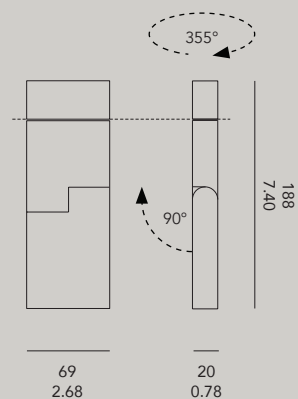

TURN.L.C.B.V.D				
Led	WW	2700K 9,6W		
	WW2	3000K 9,6W		
	NW2	4000K 9,6W		
Color body	BK	black matt ral 9011		
	WH	white matt ral 9016		
	AL	aluminium color ral 9006 (on request only)		
Beam	FI	frosted ice diffuser (wide beam)	WW	750 lm / 2700 cd
			WW2	790 lm / 2820 cd
			NW2	830 lm / 2900 cd
	MP	microprism diffuser (wide beam & anti-glare)	WW	680 lm / 1100 cd
			WW2	735 lm / 1665 cd
			NW2	770 lm / 1765 cd
	25	optic 25°	WW	485 lm / 180 cd
			WW2	510 lm / 190 cd
			NW2	535 lm / 200 cd
	40	optic 40°	WW	485 lm / 180 cd
			WW2	510 lm / 190 cd
			NW2	535 lm / 200 cd
Version	T	track mount		
	BI	built in monopoint (plasterkit required)		
Dimming	IC	fixtures individually dimmable, controlled by DALI DT6 track overall control. dimming possible with 0/1-10V, potentiometer or DALI, on 2 circuits (see pag. 76)		
	OC			
Accessories	PL.70	monopoint plasterkit 70 mm		
	TURN.25	interchangeable additional optics 25°		
	TURN.40	interchangeable additional optics 40°		
	TURN.FI	interchangeable frosted ice diffuser		
	TURN.MP	interchangeable microprism diffuser		

°turn plus ^{NEW}

material	aluminium coated / PC
weight	450gr/0,99lb
voltage	24Vdc
cri	92
wattage	13W
dali	supported DT6 (option)
rotation	355°
inclination	90°
certifications	CE 
classifications	IP20 

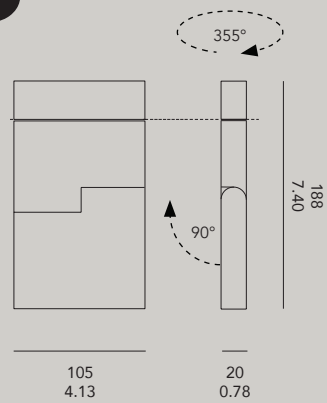

TURN.PL.L.B.O.V.C				
Led	WW	2700K 13W		
	WW2	3000K 13W		
	NW2	4000K 13W		
Body color	BK	black matt ral 9011		
	WH	white matt ral 9016		
	AL	aluminium color ral 9006 (on request only)		
Optics	10	optic 10°	WW	855 lm / 21400 cd
			WW2	940 lm / 23700 cd
			NW2	960 lm / 24750 cd
	25	optic 25°	WW	680 lm / 2580 cd
			WW2	720 lm / 2700 cd
			NW2	755 lm / 2835 cd
	35	optic 35°	WW	528 lm / 1540 cd
			WW2	690 lm / 1600 cd
			NW2	725 lm / 1680 cd
Version	T	track mount		
	BI	built in monopoint (plasterkit required)		
Control	IC	individually controlled fixture by DALI DT6		
	OC	track overall control. dimming possible with 0/1-10V, potentiometer or DALI, on 2 circuits (see pag. 76)		
Accessories	PL.105	monopoint plasterkit 105 mm		

°turn sora

NEW

material aluminium coated
weight 380gr
voltage 24Vdc
cri 95
wattage 10 / 16W
dali supported (no 0-10V dimming, only DALI)
rotation 355°
inclination 90°
certifications CE
classifications IP20 

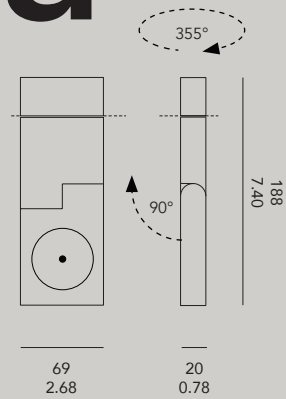

TURN.SO.L.B.V.C		
Led	10-27	10°, 2700K, SNAP compatible, max. 10W
	10-30	10°, 3000K, SNAP compatible, max. 10W
	10-40	10°, 4000K, SNAP compatible, max. 10W
	15-27	15°, 2700K, SNAP compatible, max. 16W
	15-30	15°, 3000K, SNAP compatible, max. 16W
	15-40	15°, 4000K, SNAP compatible, max. 16W
Body color	BK	black matt ral 9011
	WH	white matt ral 9016
	AL	aluminium color ral 9006 (on request only)
Version	T	track mount
	BI	built in monopoint (plasterkit required)
Control	IC	individually controlled fixture by DALI DT6
	OC	track overall controlled (if provided), no dimming possible
Accessories	PL.70	monopoint plasterkit 70 mm

Snap system for turn soraa

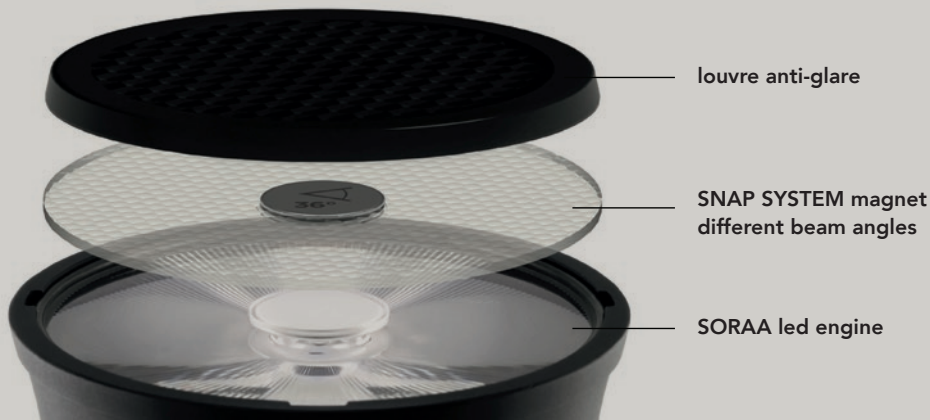

Soraa has developed an optical system that is optimized around its breakthrough GaN-on-GaN™ LED technology. The result is directional light with near perfect light distribution, exquisitely uniform color and smooth, artifact free transitions. The optical light engines deliver intensity normally associated with substantially larger diameter sources. Beam angles range from narrow spot to flood and can be combined with the SNAP System accessories to change light distribution and light color on site.

The SNAP SYSTEM's self-centering magnetic interconnect system makes using accessories completely user friendly. Simply attached the SNAP SYSTEM accessory directly to the led engine, the magnetic force from both the accessory and lamp will securely attached to one another and center itself. The accessories can be stacked in combination. For example, a beam spreader can be used in combination with CCT shifter.

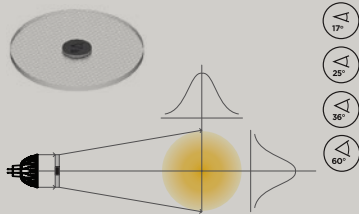

Use in any application where reducing the number of beam angle SKUs is required. Provides maximum flexibility up to the time of installation.

- TURN.SO.17** SNAP beam spreader 17°
- TURN.SO.25** SNAP beam spreader 25°
- TURN.SO.36** SNAP beam spreader 36°
- TURN.SO.60** SNAP beam spreader 60°

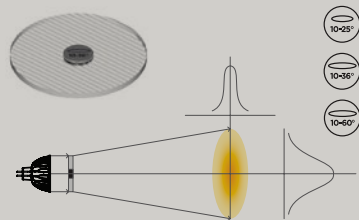

Use in wall washes and illuminating asymmetric objects. Reduces required number of light fixtures and spill.

- TURN.SO.1025** SNAP linear 10°x 25°
- TURN.SO.1036** SNAP linear 10°x 36°
- TURN.SO.1060** SNAP linear 10°x 60°

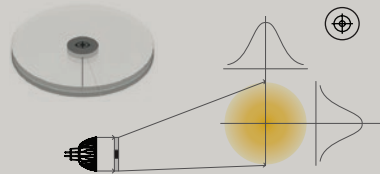

Designed with two lenses the AIM snap bends the beam from 0 degree to maximum deflection angle of 20 degrees, while maintaining uniform and consistent color and shape.

- TURN.SO.AIM** deflection angle of 20°

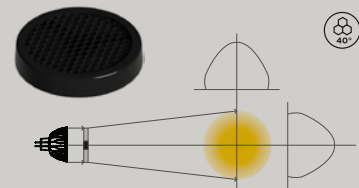

Eliminates high angle glare, making light beams disappear in downlight applications.

- TURN.SO.LOUVRE** SNAP anti-glare louvre

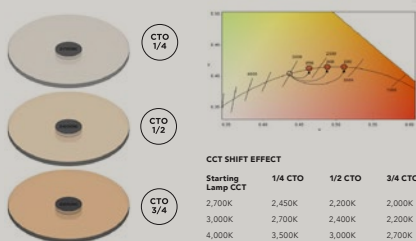

Use in hospitality and restaurant applications to simulate warm dimming. Create custom colors for festive occasions or brand identity.

- TURN.SO.CS.1/4** SNAP color shift small
- TURN.SO.CS.1/2** SNAP color shift medium
- TURN.SO.CS.3/4** SNAP color shift large

°out

material aluminium coated
weight 450gr / 0.99lb
voltage 24Vdc
cri >90
wattage 16,5W
dali supported (option) DALI DT8, tunable white
certifications CE   
classifications IP20 

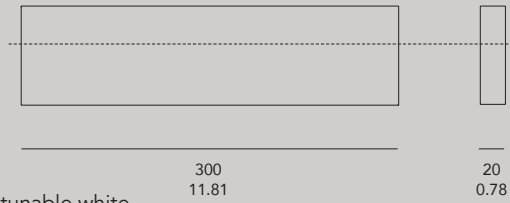

°out (FI)

OUT.L.C.D.V.D				
Led	WW	2700K 16,5W		
	WW2	3000K 16,5W		
	NW2	4000K 16,5W		
	TW	tunable white (only with IC) 18W 2200-6500°K		
Color body	BK	black matt ral 9011		
	WH	white matt ral 9016		
	AL	aluminium color ral 9006 (on request only)		
Diffuser	FI	strip frosted ice	WW	1100 lm / 600 cd
			WW2	1100 lm / 600 cd
			NW2	1100 lm / 600 cd
			TW	
	MP	strip microprism (anti-glare)	WW	1100 lm / 600 cd
			WW2	1100 lm / 600 cd
			NW2	1100 lm / 600 cd
			TW	
	SF	solid frosted	WW	1100 lm / 275 cd
			WW2	1160 lm / 290 cd
			NW2	1220 lm / 305 cd
			TW	
	SC	solid clear	WW	930 lm / 395 cd
			WW2	980 lm / 415 cd
			NW2	1030 lm / 435 cd
			TW	
	SCE	solid clear with custom etched front (300x50mm)	WW	930 lm / 395 cd
			WW2	980 lm / 415 cd
			NW2	1030 lm / 435 cd
			TW	
Version	T	track mount		
	BI	built in monopoint (plasterkit required)		
Dimming	IC	fixtures individually dimmable, controlled by DALI DT8 track overall control. dimming possible with 0/1-10V, potentiometer or DALI, on 2 circuits (see pag. 76)		
	OC			
Accessories	PL.300	monopoint plasterkit 300 mm		
	OUT.FI	interchangeable frosted ice diffuser		
	OUT.MP	interchangeable microprism diffuser		





°out with solid clear diffuser with custom etched front (SCE)



°out with solid frost diffuser (SF)

°u-disk NEW

material	aluminium coated / PMMA
weight	300gr / 0.66lb
voltage	24Vdc
cri	>90
wattage	13W
dali	supported DT6
rotation	355°
inclination	90°
certifications	CE 
classifications	IP20 

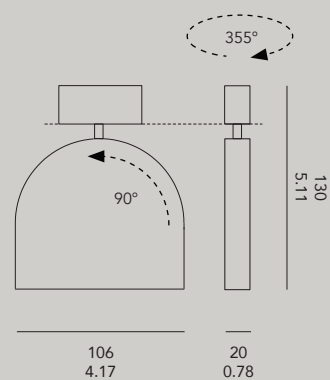

UDISK.L.B.O.V.C				
Led	WW	2700K 13W		
	WW2	3000K 13W		
	NW2	4000K 13W		
Body color	BK	black matt ral 9011		
	WH	white matt ral 9016		
	AL	aluminium color ral 9006 (on request only)		
Optics	10	optic 10°	WW	855 lm / 21400 cd
			WW2	940 lm / 23700 cd
			NW2	960 lm / 24750 cd
	25	optic 25°	WW	680 lm / 2580 cd
			WW2	720 lm / 2700 cd
			NW2	755 lm / 2835 cd
	35	optic 35°	WW	528 lm / 1540 cd
			WW2	690 lm / 1600 cd
			NW2	725 lm / 1680 cd
Version	T	track mount		
	BI	built in monopoint (plasterkit required)		
Control	IC	individually controlled fixture by DALI DT6		
	OC	track overall control. dimming possible with 0/1-10V, potentiometer or DALI, on 2 circuits (see pag. 76)		
Accessories	PL.70	monopoint plasterkit 70 mm		

°o-disk ^{NEW}

material	aluminium coated / PMMA
weight	300gr / 0.66lb
voltage	24Vdc
cri	>90
wattage	13W
dali	supported DT6
rotation	355°
inclination	90°
certifications	CE
classifications	IP20 

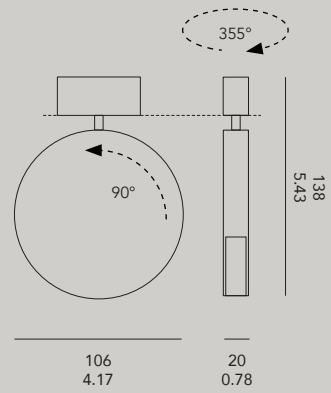

ODISK.L.B.D.V.C				
Led	WW	2700K 9,6W		
	WW2	3000K 9,6W		
	NW2	4000K 9,6W		
Body color	BK	black matt ral 9011		
	WH	white matt ral 9016		
	AL	aluminium color ral 9006 (on request only)		
Diffuser	FI	frosted ice diffuser (wide beam)	WW	245 lm / 150 cd
			WW2	255 lm / 160 cd
			NW2	270 lm / 165 cd
Version	T	track mount		
	BI	built in monopoint (plasterkit required)		
Control	IC	individually controlled fixture by DALI DT6		
	OC	track overall control. dimming possible with 0/1-10V, potentiometer or DALI, on 2 circuits (see pag. 76)		
Accessories	PL.70	monopoint plasterkit 70 mm		

°dot

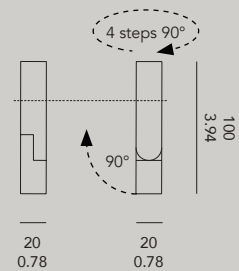

material	aluminium coated
weight	80gr / 0.17lb
voltage	24Vdc
cri	>90
wattage	3,6W
dali	not supported
rotation	4 steps of 90°
inclination	90°
certifications	CE  
classifications	IP20 



DOT.L.B.D.V

Led	WW WW2 NW2	2700K 3,6W 100 lm - 2353 cd - 8° 3000K 3,6W 105 lm - 2670 cd - 8° 4000K 3,6W 110 lm - 2800 cd - 8°
Body color	BK WH AL	black matt ral 9011 white matt ral 9016 aluminium color ral 9006 (on request only)
Dimming	OC	track overall control. dimming possible with 0/1-10V, potentiometer, on 2 circuits (see pag. 76)
Version	T BI	track mount built in monopoint (plasterkit required)
Accessories	PL.DOT	monopoint plasterkit °dot

°dot turn ^{NEW}

material aluminium coated
weight 170gr / 0.37lb
voltage 24Vdc
cri >90
wattage 3W
dali supported DT6
rotation 355°
inclination 90°
certifications  
classifications IP20 

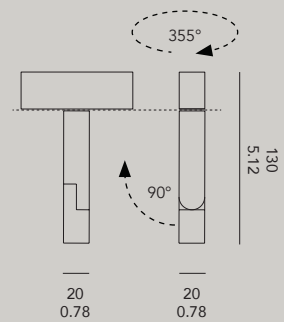

DOT.TURN.L.B.D.V		
Led	WW	2700K 3,6W 100 lm - 2353 cd - 8°
	WW2	3000K 3,6W 105 lm - 2670 cd - 8°
	NW2	4000K 3,6W 110 lm - 2800 cd - 8°
Body color	BK	black matt ral 9011
	WH	white matt ral 9016
	AL	aluminium color ral 9006 (on request only)
Dimming	IC	fixtures individually dimmable, controlled by DALI DT6
	OC	track overall control. dimming possible with 0/1-10V, potentiometer, on 2 circuits (see pag. 76)
Version	T	track mount
	BI	built in monopoint (plasterkit required)
Accessories	PL.DOTTURN	monopoint plasterkit °dot turn

° power
supply 24Vdc

PS.24.XX.SM.HLG		1-10V dimming, CE, cUL certified, 90-305VAC
40	W	171*61.5*36.8 mm (L*W*H)
60	W	171*61.5*36.8 mm
80	W	195.6*61.5*38.8 mm
100	W	220*68*38.8 mm
150	W	228*68*38.8 mm
240	W	244.2*68*38.8 mm
320	W	252*90*43.8 mm
600	W	280*144*48.5mm
DAP04		dali adaptor for dali control of power supply HLG (165*46*23 mm)

PS.24.XX.SM.ELG			0-10V dimming, CE, cUL, CCC certified, 110-305VAC
at 240V	at 110V		
75W	60W	180*63*35.5mm (L*W*H)	
100W	70W	199*63*35.5mm	
150W	105W	219*63*35.5mm	
200W	150W	244*71*37.5mm	
240W	180W	244*71*37.5mm	

PS.24.XX.SM.ELG.DA			DALI dimming, CE, cUL, CCC certified, 110-305VAC
at 240V	at 110V		
75W	60W	180*63*35.5mm (L*W*H)	
100W	70W	199*63*35.5mm	
150W	105W	219*63*35.5mm	
200W	150W	244*71*37.5mm	
240W	180W	244*71*37.5mm	

PS.24.SM.B.DIM	Potentiometer dimming button (0-10V/1-10V)
----------------	--

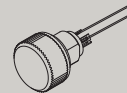

LDIM.24V	DIN rail mount dimmodule 24 VDC Max 240W controlled by 0/1-10V or potentiometer (width 25mm)
----------	--

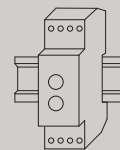

°bloc NEW

The first linear lighting system available in a wide variety of high quality materials to offer a solution to your unique requirements.

Interchangeable °bloc units clip onto a surface mounted track.

Design by etre moderne



NEW





°BLOC.SPOT walnut & brass brushed & °BLOC walnut & white carrara
House, Belgium - architect Pascal François - photograph by Thomas De Bruyne (cafeine.be)





Stone workshop



Wood workshop



Polishing brass

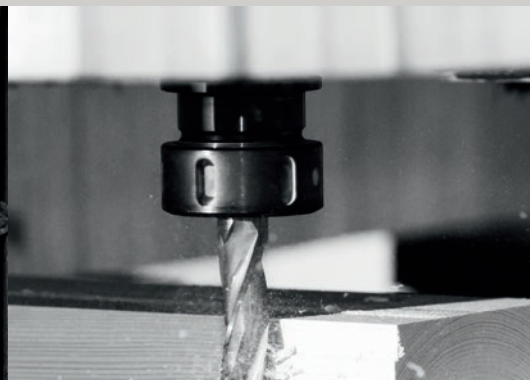

Milling wood

**We use natural materials,
selected with the greatest care.**

**They are being processed in local workshops
by professional craftsmen.**

scale 1/1

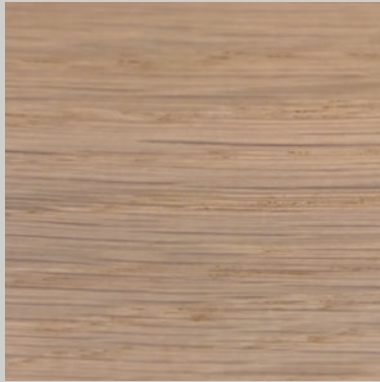

European oak (FSC 100%)



American walnut (FSC 100%)

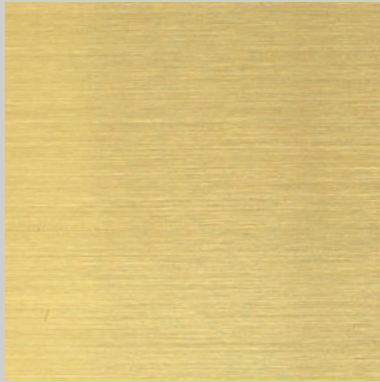

Brass brushed

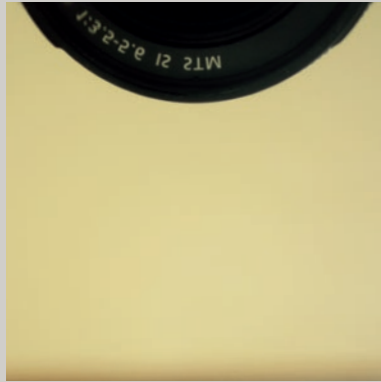

Brass polished



Italian Bianco Carrara "C"

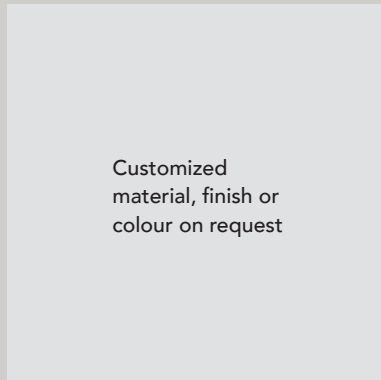

Differences in colors and patterns may occur since these are natural materials.

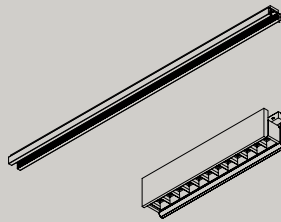

track

bloc spot

300 mm

20° or 40°, both with a black anti-glare louvre

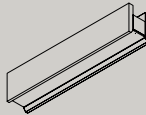

bloc stripe

300 mm

frosted ice or microprism diffuser

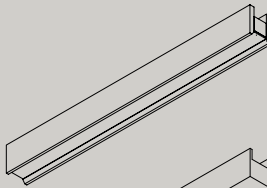

bloc stripe

600 mm

frosted ice or microprism diffuser

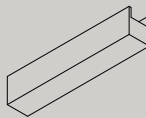

bloc

300 mm

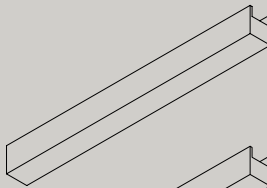

bloc

600 mm

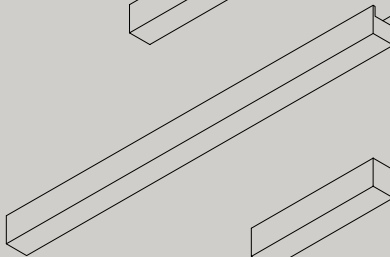

bloc

900 mm

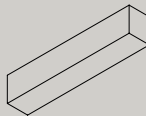

bloc end

300 mm

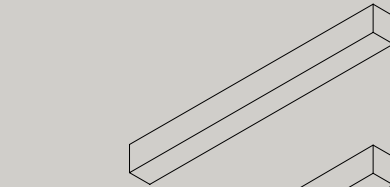

bloc end or bloc with integrated driver

600 mm



bloc end

900 mm

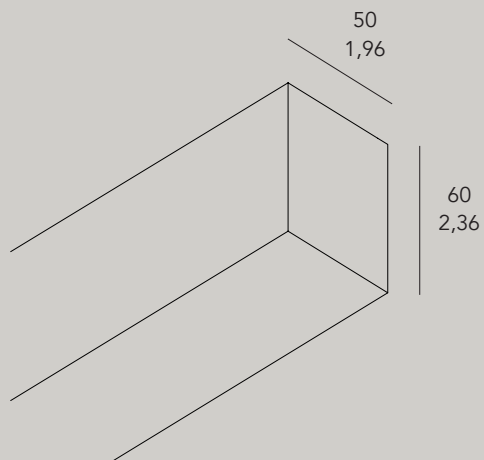

BLOC.SPOT.300.L.M.B		Bloc led spot 24Vdc		
Led	WW	2700K 13W		
	WW2	3000K 13W		
	NW2	4000K 13W		
Length	300	mm		
Material	BRA-BR	brass brushed, clear matt varnished		
	BRA-HP	brass high polished, clear varnished		
	OAK	european oak massive, clear matt varnished		
	WAL	american walnut massive, clear matt varnished		
	CAR	italian white carrara C, matt sweetened		
	WHI	aluminium, white coated		
	BLA	aluminium, black coated		
Beam	20°	spot 20°	WW	1000 lm / 3200 cd
		with black anti-glare louvre	WW2	1036 lm / 3329 cd
			NW2	1120 lm / 3500 cd
	40°	spot 40°	WW	700 lm / 365 cd
		with black anti-glare louvre	WW2	730 lm / 380 cd
			NW2	785 lm / 410 cd

BLOC.STRP.L.L.M.D		Bloc led stripe 24Vdc		
Led	WW	2700K		
	WW2	3000K		
	NW2	4000K		
Length	300	mm	13W	
	600	mm	26W	
Material	BRA-BR	brass brushed, clear matt varnished		
	BRA-HP	brass high polished, clear varnished		
	OAK	european oak massive, clear matt varnished		
	WAL	american walnut massive, clear matt varnished		
	CAR	italian white carrara C, matt sweetened		
	WHI	aluminium, white coated		
	BLA	aluminium, black coated		
Diffuser	FI	frosted ice diffuser	WW	700 lm / 365 cd
		(wide angle)	WW2	730 lm / 380 cd
			NW2	785 lm / 410 cd
	MP	microprism diffuser	WW	700 lm / 365 cd
		(wide angle & anti-glare)	WW2	730 lm / 380 cd
			NW2	785 lm / 410 cd



BLOC.L.M.V		Bloc without light
Length	300	mm
	600	mm
	900	mm
	custom	on request (possible lengths depend on the kind of material)
Material	BRA-BR	brass brushed, clear matt varnished
	BRA-HP	brass high polished, clear varnished
	OAK	european oak massive, clear matt varnished
	WAL	american walnut massive, clear matt varnished
	CAR	italian white carrara C, matt sweetened
	WHI	aluminium, white coated
	BLA	aluminium, black coated
Version	END	bloc closed at one side (at the beginning or the end of the track)
BLOC.LD.M.LD		Bloc with an integrated led driver 600 mm
Material	BRA-BR	brass brushed, clear matt varnished
	BRA-HP	brass high polished, clear varnished
	OAK	european oak massive, clear matt varnished
	WAL	american walnut massive, clear matt varnished
	CAR	italian white carrara C, matt sweetened
	WHI	aluminium, white coated
	BLA	aluminium, black coated
Led Driver	US	100W input 110-240 Vdc DALI supported
	EU	100W input 220-240 Vdc DALI supported
	24V	remote, see p. 76

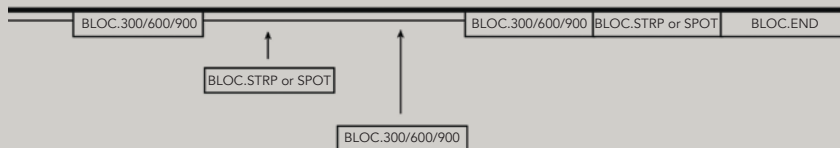

- BLOC.STRP or BLOC.SPOT don't fit to each other; these must be always separated by a BLOC (without led)
- BLOC.END isn't available with led.



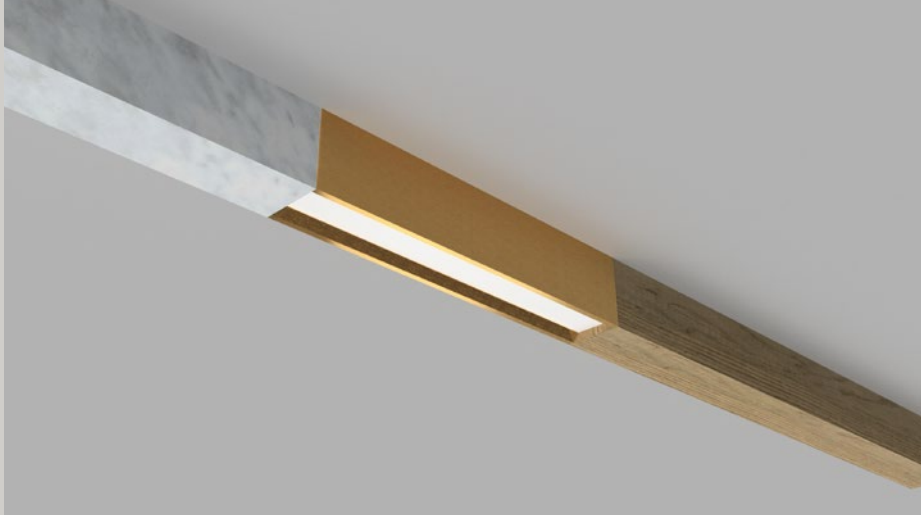

BLOC.STRP.300 with frosted ice diffuser



BLOC.STRP.600, with frosted ice diffuser



BLOC.SPOT.300, 20° or 40°, with black anti-glare louvre

°hide-out NEW

Hide-out is a 24 Vdc recessed track system which offers a great flexibility in terms of moving around the LED lighting fixtures 'nook' and 'tag' since they don't have a power cable. This means that any person can move the lighting fixtures since there is no need of connecting wires. The lighting fixtures have a hinge system which makes that you can hide them inside the ceiling or pull them out. Optionally available with indirect ambient lighting. Hide-out is available in black and white.

Design by Eden Design



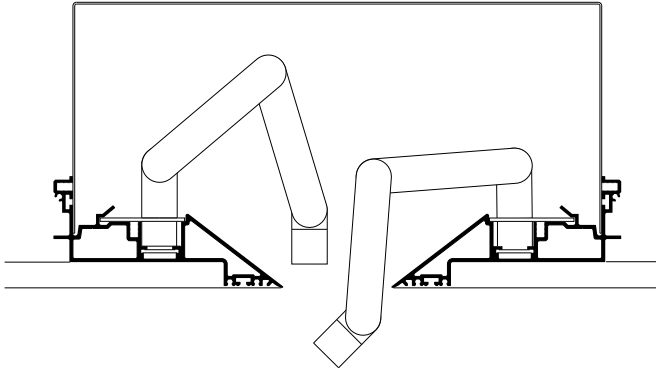



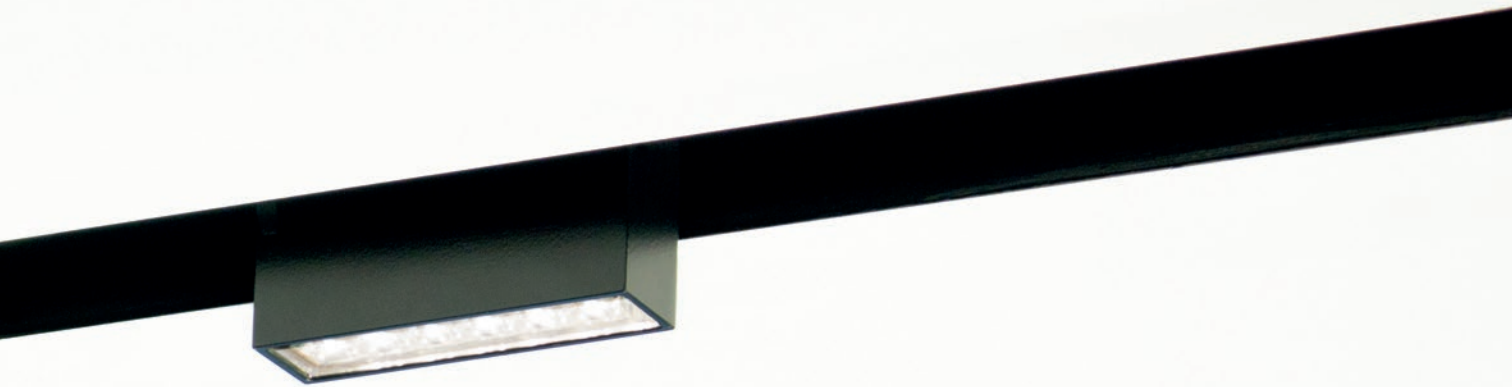



°hide-out ^{NEW}

material	aluminium coated
weight	80gr / 0.17lb
voltage	24Vdc
max	240W (on length of 4m)
dimming	1-10V / 0-10V / DALI
certifications	CE 
classifications	IP20 

HIDEOUT single track

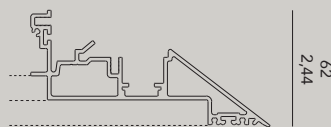

130
5,11

plasterboard 12,5mm (0,5inch)

HIDEOUT double track with cover

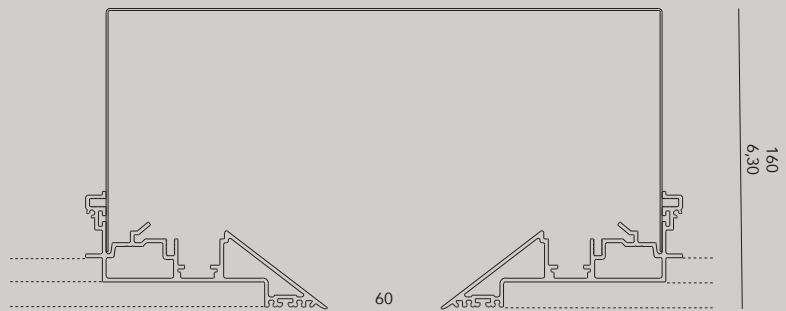

60
2,36

320
12,59

HIDEOUT.L.C.V

Length	4000	standard length in mm
	300 - ...	custom length in mm
Color body	BK	black matt ral 9011
	WH	white matt ral 9016
	AL	aluminium color ral 9006 (on request)
Version	SI	single track
	DU	double track

Cover

End Cap

HIDE.OUT.CO.WH
HIDE.OUT.CO.BL

HIDE.OUT.EC.WH
HIDE.OUT.EC.BL

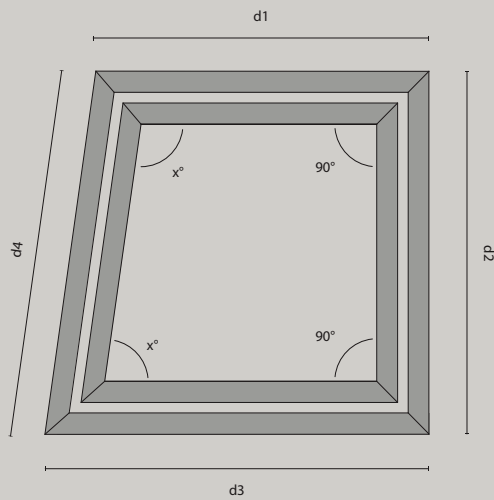
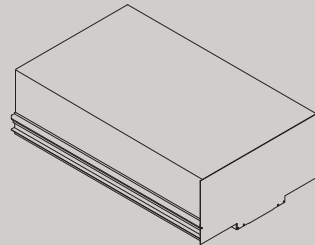
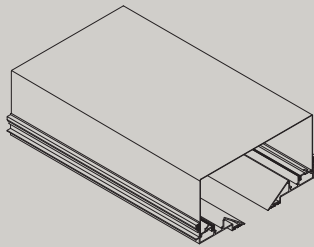

Mention the outside dimensions of the tracks and the inner corners

°nook NEW

material	aluminium coated
weight	400 gr
voltage	24Vdc
cri	>90
wattage	18W
dali	supported DT8 (option) tunable white
certifications	CE
classifications	IP20 



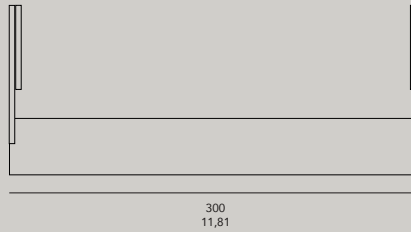
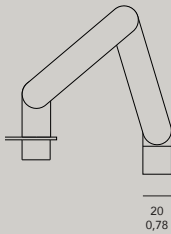

NOOK.L.C.D.D

Led	WW	2700K 16,5W		
	WW2	3000K 16,5W		
	NW2	4000K 16,5W		
	TW	tunable white (only with IC) 18W 2200-6500°K		
Color body	BK	black matt ral 9011		
	WH	white matt ral 9016		
	AL	aluminium color ral 9006 (on request only)		
Diffuser	FI	frosted ice diffuser (wide beam)	WW	1300 lm / 530 cd
			WW2	1300 lm / 530 cd
			NW2	1300 lm / 530 cd
			TW	
	MP	microprism diffuser (wide beam & anti-glare)	WW	1300 lm / 600 cd
			WW2	1300 lm / 600 cd
			NW2	1300 lm / 600 cd
			TW	
Dimming	IC	fixtures individually dimmable, controlled by DALI DT8 track overall control. dimming possible with 0/1-10V, potentiometer or DALI, on 2 circuits (see pag. 76)		
	OC			

o'tag NEW

material	aluminium coated
weight	200gr
voltage	24Vdc
cri	>90
wattage	9,6W
dali	supported DT6
certifications	CE
classifications	IP20 



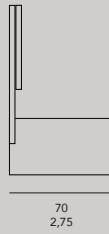
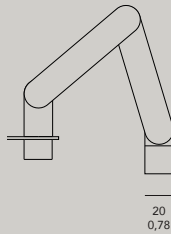

TAG.L.C.D.D

Led	WW	2700K 9,6W		
	WW2	3000K 9,6W		
	NW2	4000K 9,6W		
Color body	BK	black matt ral 9011		
	WH	white matt ral 9016		
	AL	aluminium color ral 9006 (on request only)		
Diffuser	25°	25° lens	WW	750 lm / 2700 cd
			WW2	790 lm / 2820 cd
			NW2	830 lm / 2900 cd
	40°	40° lens	WW	680 lm / 1100 cd
			WW2	735 lm / 1665 cd
			NW2	770 lm / 1765 cd
NW2	725 lm / 1680 cd			
Dimming	IC	fixtures individually dimmable, controlled by DALI		
	OC	track overall control. dimming possible with 0/1-10V, potentiometer or DALI, on 2 circuits (see pag. 76)		

°ledline

Continuous lines of light, without limits.

Each led module can be cut every 8 cm, this gives architects and lighting designers a lot of flexibility.

Led line has a very good efficiency. A high-tech diffuser was implemented to block as little light as possible and still give an opal look.

Led line can be installed surface mounted, recessed and pendant. It is available in two control options: DALI & 1-10V. Available in anodized aluminum, black or white.







°led line 25

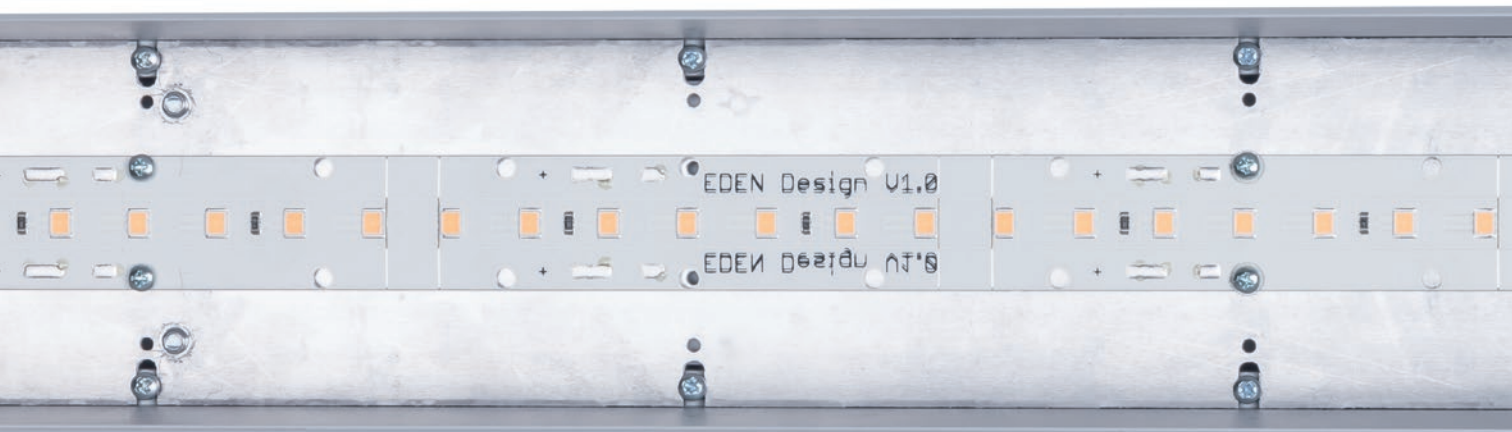



°led line 60







°ledline 25

material	anodised aluminium coated
weight	0,8 kg/m - 0,52 lb/ft
voltage	24Vdc
cri	>90
wattage	13 or 28W / meter
dali	supported DT6 option
certifications	CE  
classifications	IP20 

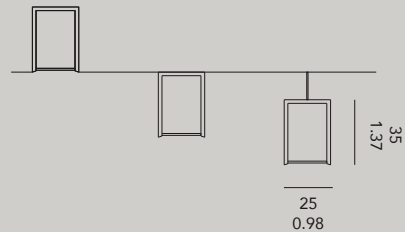

LL25.L.B.T.K		led modules cuttable every 8 cm
Length	2000 100 - ...	standard length custom length
Body color	BK WH AL	black matt ral 9011 white matt ral 9016 aluminium color ral 9006 (on request only)
Type	BI SM PD	recessed surface mount pendant
K	WW.13 WW2.13 NW2.13 WW.28 WW2.28 NW2.28	2700K 13W 960 lm/m 3000K 13W 1020 lm/m 4000K 13W 1020 lm/m 2700K 28W 1650 lm/m 3000K 28W 1780 lm/m 4000K 28W 1850 lm/m
Accessories	LL25.EC.BK LL25.EC.WH LL25.EC.AL LL25.MB	led line 25 End Cap Black led line 25 End Cap White led line 25 End Cap Aluminium Mounting Bracket for recessed mounting
Driver		See p. 76

°ledline 60

107

material	anodised aluminium coated
weight	2,5 kg/m - 1,65 lb/ft
voltage	240 Vac
cri	>90
wattage	28W / meter
dali	supported DT6 option
certifications	CE   
classifications	IP20 

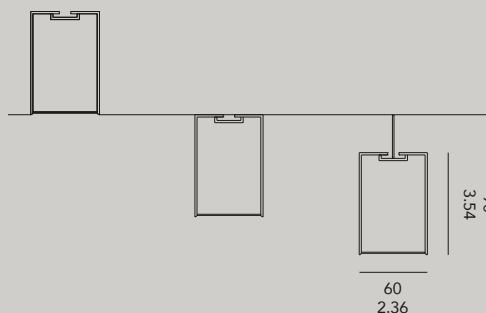

LL60.L.B.T.K.D		led modules cuttable every 8 cm
Length	2000 100 - ...	standard length custom length
Body color	BK WH AL	black matt ral 9011 white matt ral 9016 aluminium color anodised (on request only)
Type	BI SM PD	recessed surface mount pendant
K	WW.28 WW2.28 NW2.28	2700K 28W 1650 lm/m 3000K 28W 1780 lm/m 4000K 28W 1850 lm/m
Driver (integrated)	ND DA DA2 10V	Non dimmable 100-240VAC DALI 220-240VAC DALI 100-240VAC 1-10V 100-240VAC
Accessories	LL60.EC.BK LL60.EC.WH LL60.EC.AL LL60.MB LL60.MC.ST LL60.MC.90°	led line 25 End Cap Black led line 25 End Cap White led line 25 End Cap Aluminium Mounting Bracket for recessed mounting Mechanical Connector plate Straight Mechanical Connector plate 90°

°oh!led **NEW**

Raising lighting to a new level. In the past OLED has mainly been used for decorative and ambient lighting. OLED stands for Organic LED and produces a natural glare-free light. This innovative OLED luminaire has a lumen output of 300lm from a single 12,7 cm sheet, which makes it the brightest commercially available OLED in the world and makes it perfectly suitable for functional lighting. This sleek panel, mainly made out of aluminium and glass is less than 5mm thick!

Design by Bart Lens











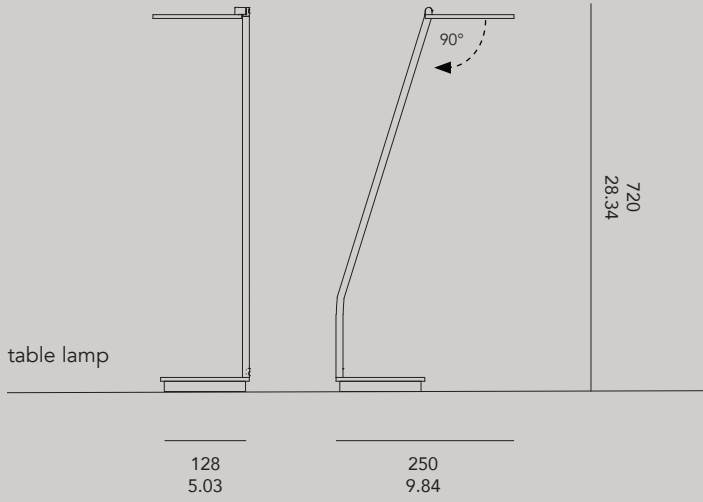
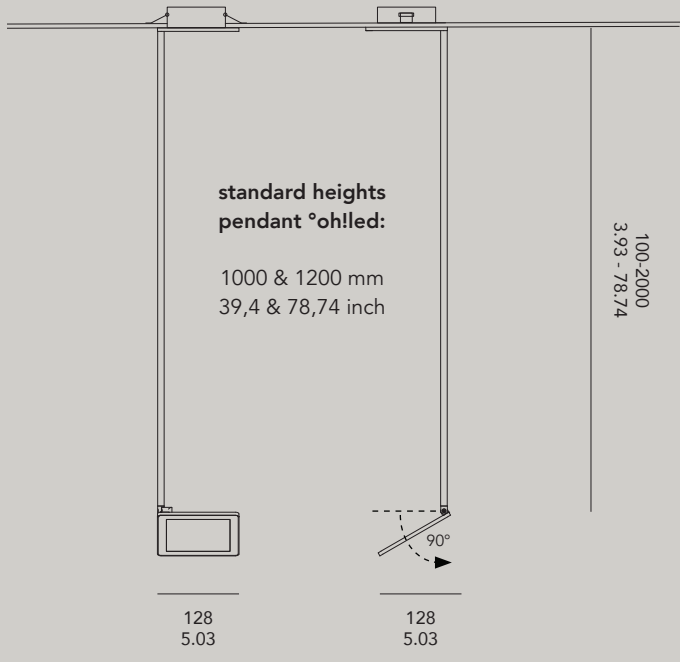

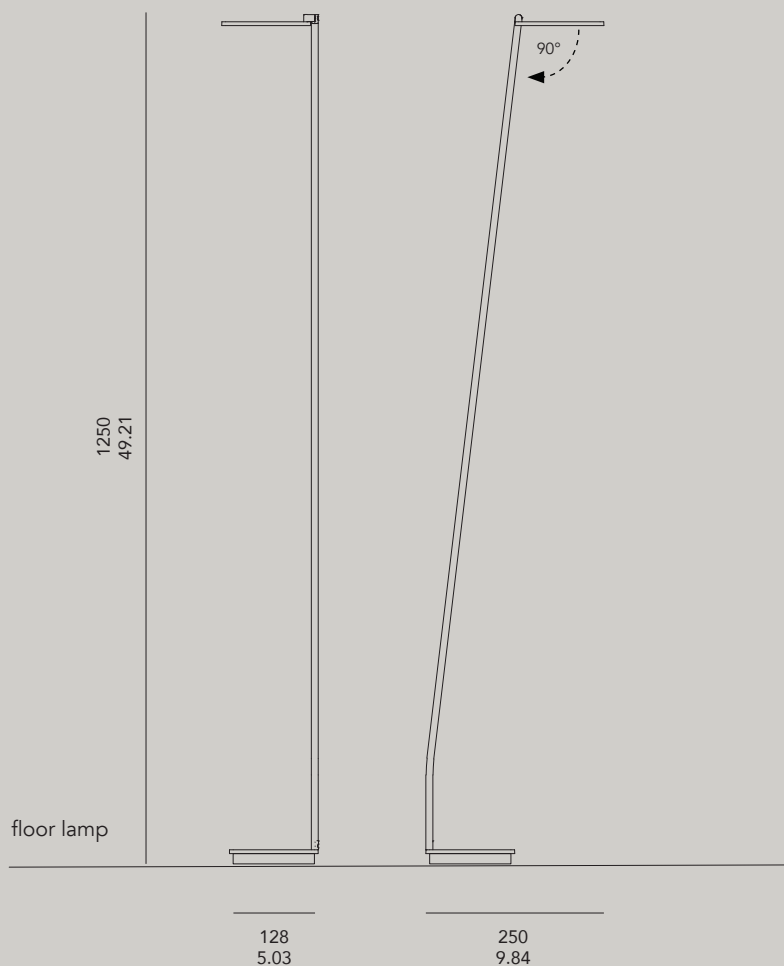

°oh!led

CE ENEC

- OH.WH.10V** pendant oh!led white (incl. ceiling rose), dimmable 1-10V
OH.BK.10V pendant oh!led black (incl. ceiling rose), dimmable 1-10V
OH.WH.DAL pendant oh!led white (incl. ceiling rose), dimmable DALI
OH.BK.DAL pendant oh!led black (incl. ceiling rose), dimmable DALI

standard length 1000 & 1200 mm / 39,4 & 78,74 inch
 other lengths (from 100 to 2000 mm) on request

- OH.TA.WH** table lamp oh!led white
OH.TA.BK table lamp oh!led black
- OH.FL.WH** floor lamp oh!led white
OH.FL.BK floor lamp oh!led black

coated aluminium - 6,5W, 3000K, 300lm, 100-260VAC, IP20 - weight pendant 0,8kg-1,8lb / table 3,5kg-7,7lb / floor 4,6kg-10,1lb

°sphere

Belgian architect Bart Lens needed a large lamp that would create an encircling sphere of light above the conference table in their office, and so began the search. After a long and fruitless quest, he finally decided to design his own mega-light with the “sphere” of a dome. The result has been likened to a “Calimero” dome, a giant bell, a half moon.... Everybody seems to have a different name for it.

Design by Bart Lens









°sphere large / House Roeselare, Belgium - architect Lens°ass - photograph by Bieke Claessens



°sphere large / "Rabbit Hole", Belgium - architect Lens°ass - photograph by Philippe van Gelooven







°sphere large / Wagamama restaurant, Wembley, London







°sphere large with imitation gold leaf / MRKT - Hirshleifers, NY, USA



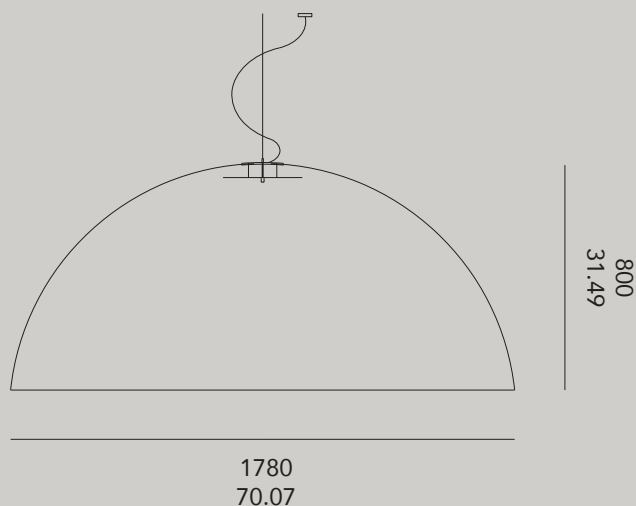

°sphere large 178



SPH.L.127.000	1 x E27 socket - excl lamp
SPH.L.227.000	2 x E27 socket - excl lamps
SPH.L.327.000	3 x E27 socket - excl lamps
SPH.L.427.000	4 x E27 socket - excl lamps
SPH.L.227.OPD	2 x E27 socket with pull dimmer - excl. light bulbs
SPH.L.327.OPD	3 x E27 socket with pull dimmer - excl. light bulbs
SPH.L.2200.000	TL circuline 22W, 3000K
SPH.L.0040.000	TL circuline 40W, 3000K
SPH.L.0055.000	TL circuline 55W, 3000K
SPH.L.2240.000	TL circ 22W + 40W, 3000K
SPH.L.2240.10V	TL circ 22W + 40W, dimmable 1-10V, 3000K
SPH.L.2240.DAL	TL circ 22W + 40W, dimmable DALI, 3000K
SPH.L.2255.000	TL circ 22W + 55W, 3000K
SPH.L.2255.DAL	TL circ 22W + 55W, dimmable DALI, 3000K
SPH.L.2200.127	TL circ 22W + 1 x E27 socket, 3000K
SPH.L.0040.127	TL circ 40W + 1 x E27 socket, 3000K
SPH.L.2240.127	TL circ 22W + 40W + 1 x E27 socket, 3000K
SPH.L.1LED.10V	1 x LED module 3000lm cri90+, 37,5W, dimmable (1-10V)*
SPH.L.1LED.DAL	1 x LED module 3000lm cri90+, 37,5W, dimmable (DALI)*
SPH.L.3LED.PHA	3 x LED module 3750lm cri90+, 46,5W, dimmable (phase cut)*
SPH.L.3LED.10V	3 x LED module 9000lm cri90+, 112,5W, dimmable(1-10V)*
SPH.L.3LED.DAL	3 x LED module 9000lm cri90+, 112,5W, dimmable(DALI)*
SPH.L.LEDV2.DAL	1 x LED disc 4000lm, 3000K

*2700K Warm white, 3000K on request

PLX.SPH.50 coverplate diffuser plexi 50 cm Ø

material: ABS plastic, optional RAL colors / gold leaf both inside and out - weight: 25,5 kg / 899,48 oz
included : 2 m cable, ceiling rose and suspension - 230VAC - max 250W



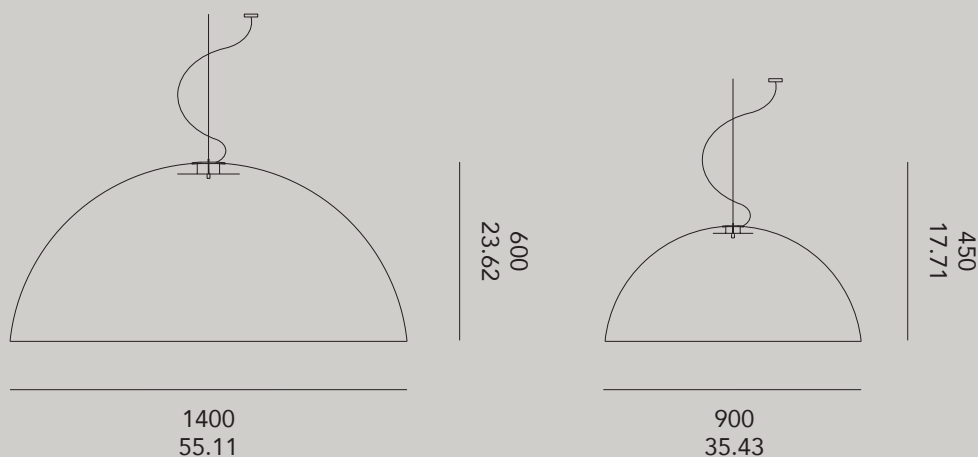

°sphere medium 140

°sphere small 90



SPH.M.127.000	SPH.S.127.000	1 x E27 socket - excl lamp
SPH.M.227.000	SPH.S.227.000	2 x E27 socket - excl lamps
SPH.M.327.000	SPH.S.327.000	3 x E27 socket - excl lamps
SPH.M.427.000	SPH.S.427.000	4 x E27 socket - excl lamps
SPH.M.227.0PD	SPH.S.227.0PD	2 x E27 socket with pull dimmer - excl. light bulbs
SPH.M.327.0PD	SPH.S.327.0PD	3 x E27 socket with pull dimmer - excl. light bulbs
SPH.M.2200.000	SPH.S.2200.000	TL circuline 22W
SPH.M.0040.000	SPH.S.0040.000	TL circuline 40W
SPH.M.0055.000	SPH.S.0055.000	TL circuline 55W
SPH.M.2240.000	SPH.S.2240.000	TL circ 22W + 40W
SPH.M.2240.10V	SPH.S.2240.10V	TL circ 22W + 40W, dimmable 1-10V
SPH.M.2240.DAL	SPH.S.2240.DAL	TL circ 22W + 40W, dimmable DALI
SPH.M.2255.000	-	TL circ 22W + 55W
SPH.M.2255.DAL	-	TL circ 22W + 55W, dimmable DALI
SPH.M.2200.127	SPH.S.2200.127	TL circ 22W + 1 x E27 socket
SPH.M.0040.127	SPH.S.0040.127	TL circ 40W + 1 x E27 socket
SPH.M.2240.127	SPH.S.2240.127	TL circ 22W + 40W + 1 x E27 socket
SPH.M.1LED.PHA	SPH.S.1LED.PHA	1 x LED module 1250lm cri90+, 15,5W, dimmable (phase cut) 2700K warm white*
SPH.M.1LED.10V	-	1 x LED module 3000lm cri90+, 37,5W, 2700K warm white*, dimmable (1-10V)
SPH.M.1LED.DAL	-	" dimmable (DALI)
SPH.M.3LED.PHA	-	3 x LED module 3750lm cri90+, 46,5W, Dimmable (phase cut) 2700K warm white*
SPH.M.3LED.10V	-	3 x LED module 9000lm cri90+, 112,5W, 2700K warm white*, dimmable (1-10V)
SPH.M.3LED.DAL	-	" dimmable (DALI)
SPH.M.LEDV2.DAL	-	1 x LED disc 4000lm + coverplate, 3000K
		*3000K on request
PLX.SPH.35		coverplate plexi 35 cm Ø
PLX.SPH.50		coverplate plexi 50 cm Ø

material: ABS plastic, optional RAL colors / gold leaf both inside and out - weight M: 13,5 kg - 476 oz - weight S: 5 kg - 176 oz
 included: 2 m cable, ceiling rose and suspension - 230VAC - sphere small: max 100W - sphere medium: max 150W

lightsources for °sphere

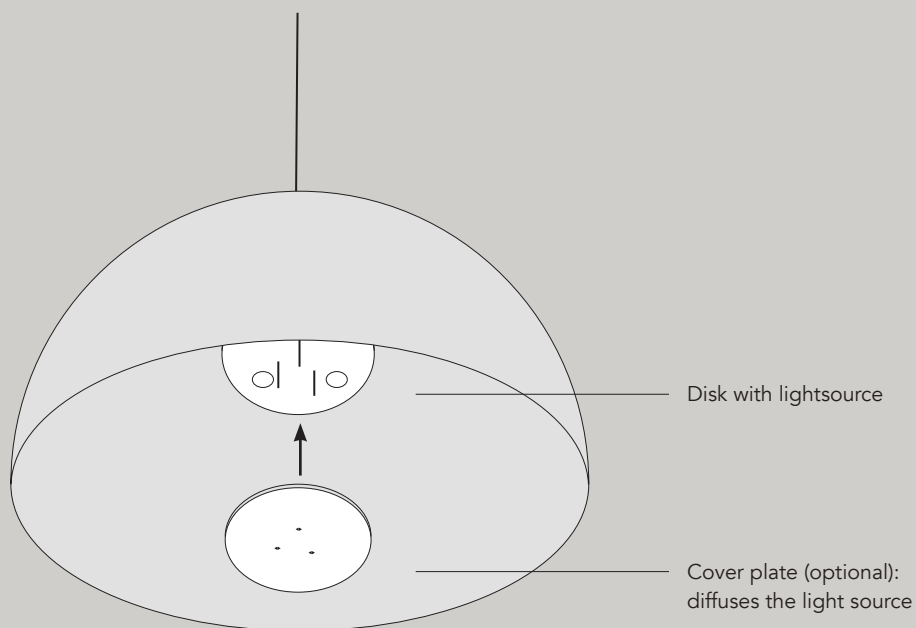

1 x socket E27 (diam. 150mm)
excl. light bulbs



3 x socket E27 (diam. 300mm)
excl. light bulbs



1 x LED module (diam. 300mm)



1 x LED disc (diam. 315mm)
with coverplate 350mm (incl.)
(equal light source)

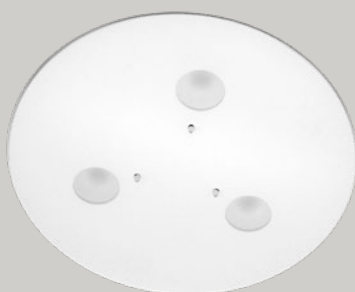

3 x LED module (diam. 400mm)



2 x TL circuline (diam. 300mm)
excl. light bulbs

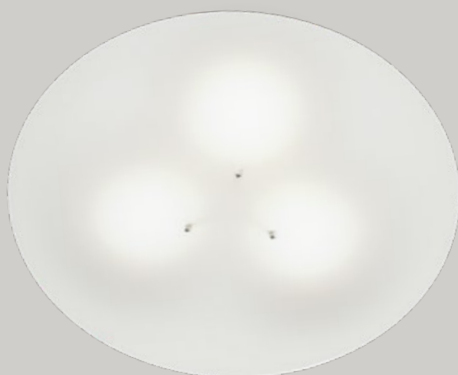

3 x LED module (diam. 400mm) or
3 x E27 (diam. 300mm)
with cover plate 500mm

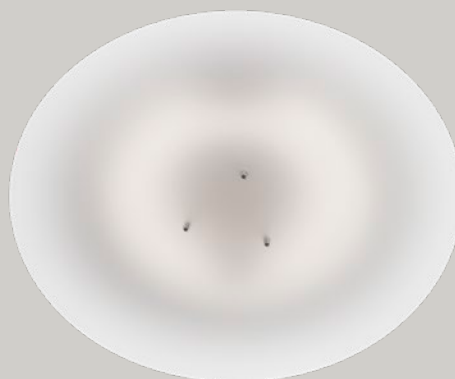

2 x TL circuline (diam. 300mm)
with coverplate 500mm

°led on fire

In a T-restaurant in Peking (China), Mr. Lens was eating at an immense mirror table with candles hanging above him. It was cozy, romantic, but also streamlined and modern. For another design we already experimented with hanging led-lights suspended from low charged wires. We marveled at the vision of a completely accidental, out-of-the box combination of a led underneath a burning candle. The effect of the translucent candle-emulsion was also heartwarming. The apparition of a led fixture, burning, not at all kitschy, with light shimmering through the material structure is imprinted in our minds. “The led is on fire”, we tried it out.

Design by Bart Lens









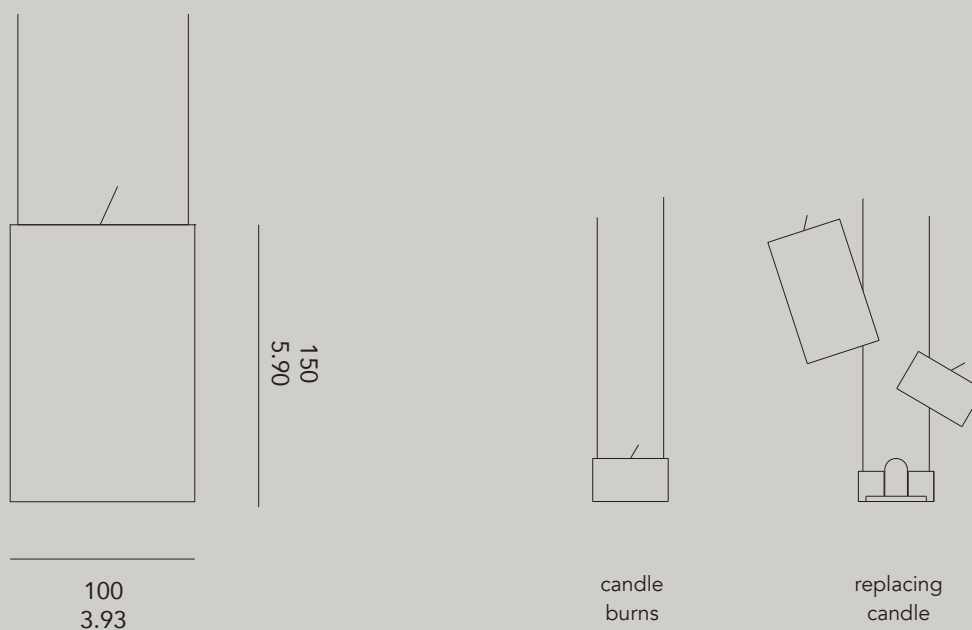

°led on fire



LOF led on fire, 2700K

Accessories

LOF.ROS.T ceiling rose round Trimless
LOF.ROS.R ceiling rose round Recessed
LOF.ROS.S ceiling rose round Surface mount, single piece
LOF.ROS.S3 ceiling rose rectangle Surface mount, three pieces
LOF.FC replacement wax candle

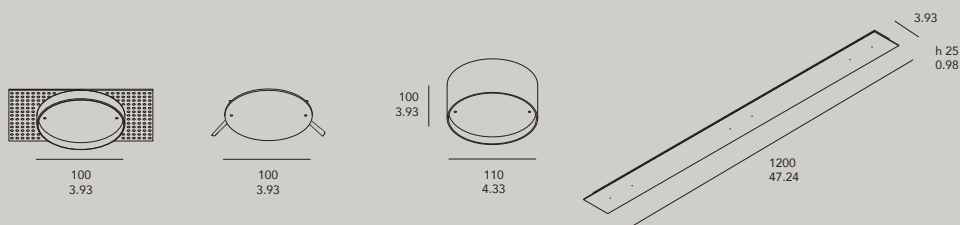

materials: aluminium, glass, wax candle - weight: 1,2 kg / 42,3 oz - indoor use - 230VAC - max. 4W
 included: 2m cables and LED driver 1-10V or Dali dimmable (on request)

°fool moon

People have always been fascinated by the light of a perfect circle. The returning full moon and the natural phenomena ascribed to it (higher childbirth percentage, fertility, transformation from human to animal, etc.), the archetypical form of a UFO, the shape of a gong, the sun... are but a few striking examples. Despite its shape of a full circle ('full moon'), the lamp can be used in several positions: horizontally, diagonally, obliquely or vertically ('fool moon'). Thanks to its large dimensions, the lamp is easily recognisable and has the possibility of demarcating or creating spaces. The lamp also has a highly symbolic value due to its imposed abstraction.

Design by Bart Lens









fool moon wall 1 / Mendeli Street Hotel, Tel-Aviv - ST-OR - lighting designer Ailon Gavish, Studio Twilight - photograph by Omri Amsalem



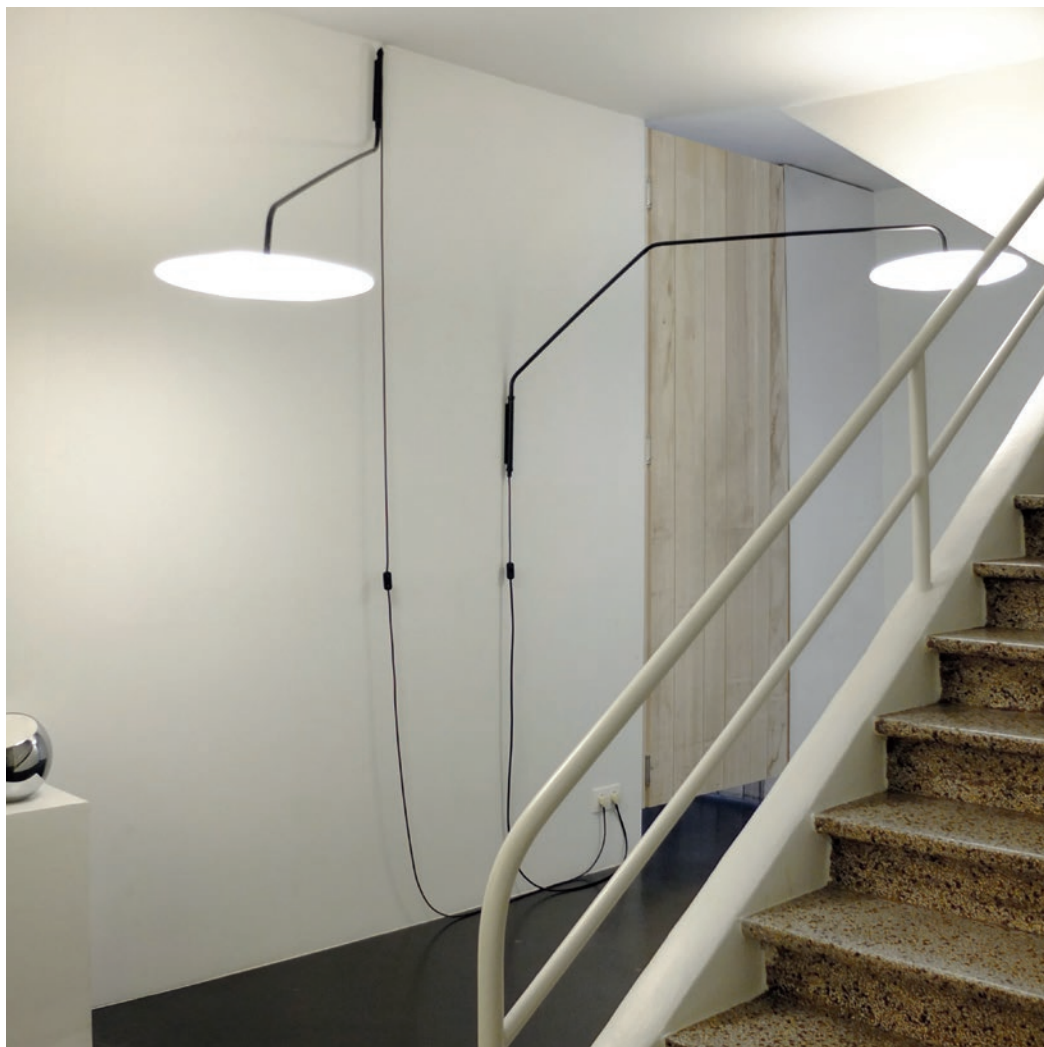















°fool moon large



FM.L.355.000	3 x PL 55W, 3000K
FM.L.355.10V	3 x PL 55W dimmable 1-10V, 3000K
FM.L.355.DAL	3 x PL 55W dimmable DALI, 3000K
FM.L.355.RGB.DMX	3 x PL 55W + RGB LED - DMX controllable
FM.L.355.RGB.DAL	3 x PL 55W + RGB LED - DALI controllable
FM.L.355.RGB.M	3 x PL 55W + RGB LED - master with remote control
FM.L.355.RGB.S	3 x PL 55W + RGB LED - slave (master required)

°fool moon medium



FM.M.324.000	3 x PL 24W, 3000K
FM.M.324.10V	3 x PL 24W dimmable 1-10V, 3000K
FM.M.000.RGB.DMX	RGB LED DMX controllable
FM.M.000.RGB.DAL	RGB LED DALI controllable
FM.M.000.RGB.M	RGB LED - master with remote control
FM.M.000.RGB.S	RGB LED - slave (master required)

°fool moon small



FM.S.3LED.000	3 x led 5W, E14 socket, phase-cut dimmable, 2700K
FM.S.RGB.DMX	RGB LED DMX controllable, driver remote (in ceiling)
FM.S.RGB.DAL	RGB LED DALI controllable, driver remote (in ceiling)
FM.S.RGB.M	RGB LED - master with remote control
FM.S.RGB.S	RGB LED - slave (master required)

material: PE - weight L: 33 kg - 1164 oz - weight M: 20 kg - 705 oz - weight S: 3 kg - 105 oz

FM large max. 200W - FM medium max. 72W - FM small max.15W - 230VAC

included: 2 m cable, ceiling rose and suspension elements





°fool moon wall type



FM.S.3LED.WALL1	3 x led 5W, E14 socket, phase-cut dimmable, 2700K
FM.S.3LED.WALL2	3 x led 5W, E14 socket, phase-cut dimmable, 2700K

materials: PE & steel - weight: 4,5 kg / 158 oz - 230VAC - max. 15W

°LEDit-bi

LEDit-Bi is a wall lamp shining in two directions (Bi-directional). The shade is built up out of two materials (Bi-material cover). The aluminium profile holds a foil that in its material and color can be adapted to your interior and style. As well with the light as with the design of the shade, an accent is set. The here used light sources are standard available bulbs. Any replacement is easy and assured.

Design by Stan Maes





°LEDit-Bi high, white, oak diffuser



°LEDit-Bi low, white, oak diffuser



°LEDit-Bi high, black, oak diffuser







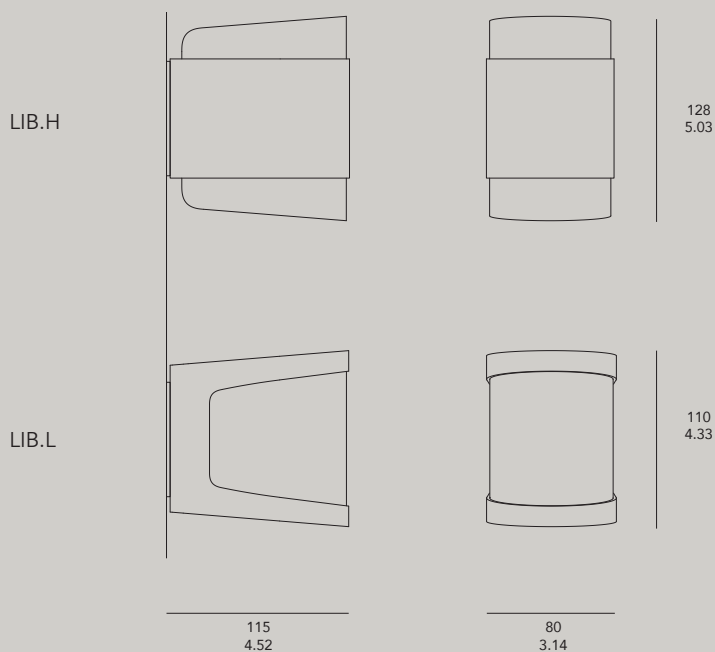

°LEDit-Bi low, white, blue PP diffuser



°LEDit-Bi high, black, brushed brass diffuser

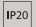

LIB.H.C.D		GU9 fitting	  
Color body	BK WH	black matt ral 9011 white matt ral 9016	
Diffuser	BRA.BR BRA.HP OAK WAL CUS	brass brushed brass high polish oak veneer walnut veneer custom digital print on opal polypropylene (PP) sheet	
LIB.L.C.D		GU9 fitting	  
Color body	BK WH	black matt ral 9011 white matt ral 9016	
Diffuser	BRA.BR BRA.HP OAK WAL CUS	brass brushed brass high polish oak veneer walnut veneer custom digital print on opal polypropylene (PP) sheet	

°XXXL(amp)

Perhaps symptomatic of an architect's mindset, the lamps and objects are becoming increasingly 'space defining'. The xxxl(amp) is essentially a flattened dome, inspired by the shape of a Chinese lantern. The twelve-segment construction makes the connection with the lantern, but a pumpkin is perhaps the first association that comes to mind, while the suspension system recalls an upside-down hot-air balloon. If the ceiling is high, but not overly high, the lamp can be hung at about 1.50m. As befits any impressive space, you'll want to enter with a slight bow. Once seated at the dining or conference table, you'll still retain a sense of the surroundings beyond the boundary. Hanging a half or a quarter xxxl(amp) in a mirrored room creates an impression of spacious rooms full of giant lanterns.

Design by Bart Lens











Belgian TV-show 'Volt'









Maison Bettant, Lyon - architect Mona LISA - Christophe Millet - photograph by Five 5 Star - lightdesign Inédit

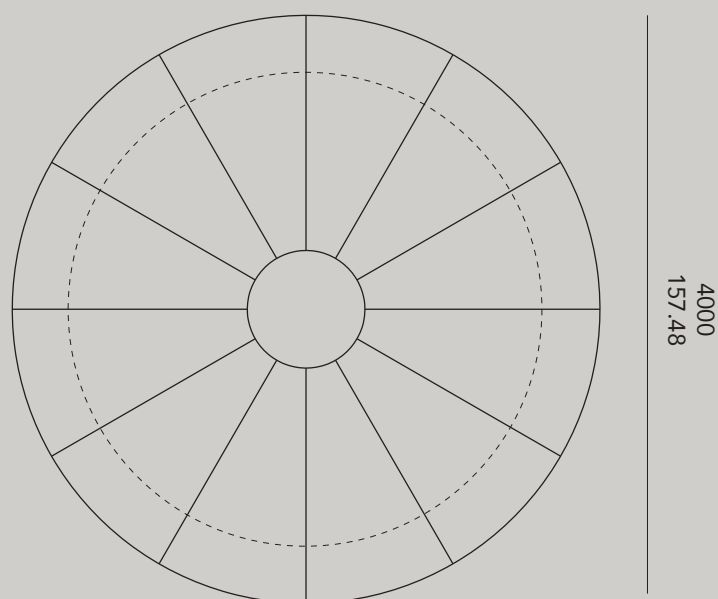
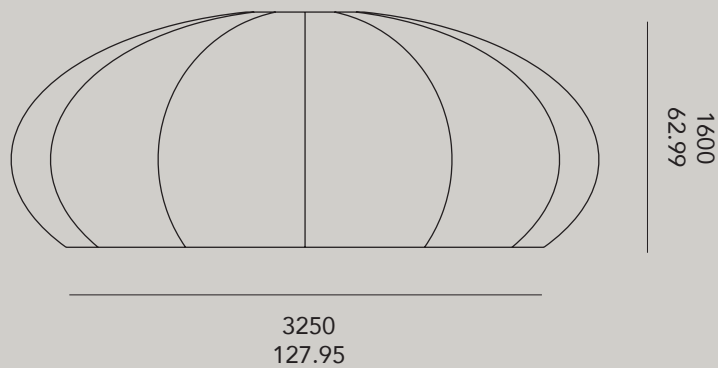

°XXXL(amp)



XXXL.927.000	XXXL(amp) standard 9 x E27 - excl. lamps
XXXL.927.RGB.M	XXXL(amp) 9 x E27 socket + RGB LED master + remote control
XXXL.927.RGB.S	XXXL(amp) 9 x E27 socket + RGB LED slave
XXXL.927.RGB.DMX	XXXL(amp) 9 x E27 socket + RGB LED DMX controllable
XXXL.927.RGB.DAL	XXXL(amp) 9 x E27 socket + RGB LED DALI controllable

material: PE - weight: 355 kg / 12.525 oz - 230VAC - max 1500W

included: 4 m / 155 in cables & 12 suspension elements, lighting element with 2 m / 78 in suspension bar

°diabolo

Two hemispheres, a couple or twins, of which one of them is lighted by LED and rotates $190^\circ / 360^\circ$ on its axis. Single or in line, it evokes images of a solar eclipse, a chesterfield chair or a diabolo toy. Available as table-lamp, wall lamp or ceiling lamp and in several colors.

Design by Bart Lens



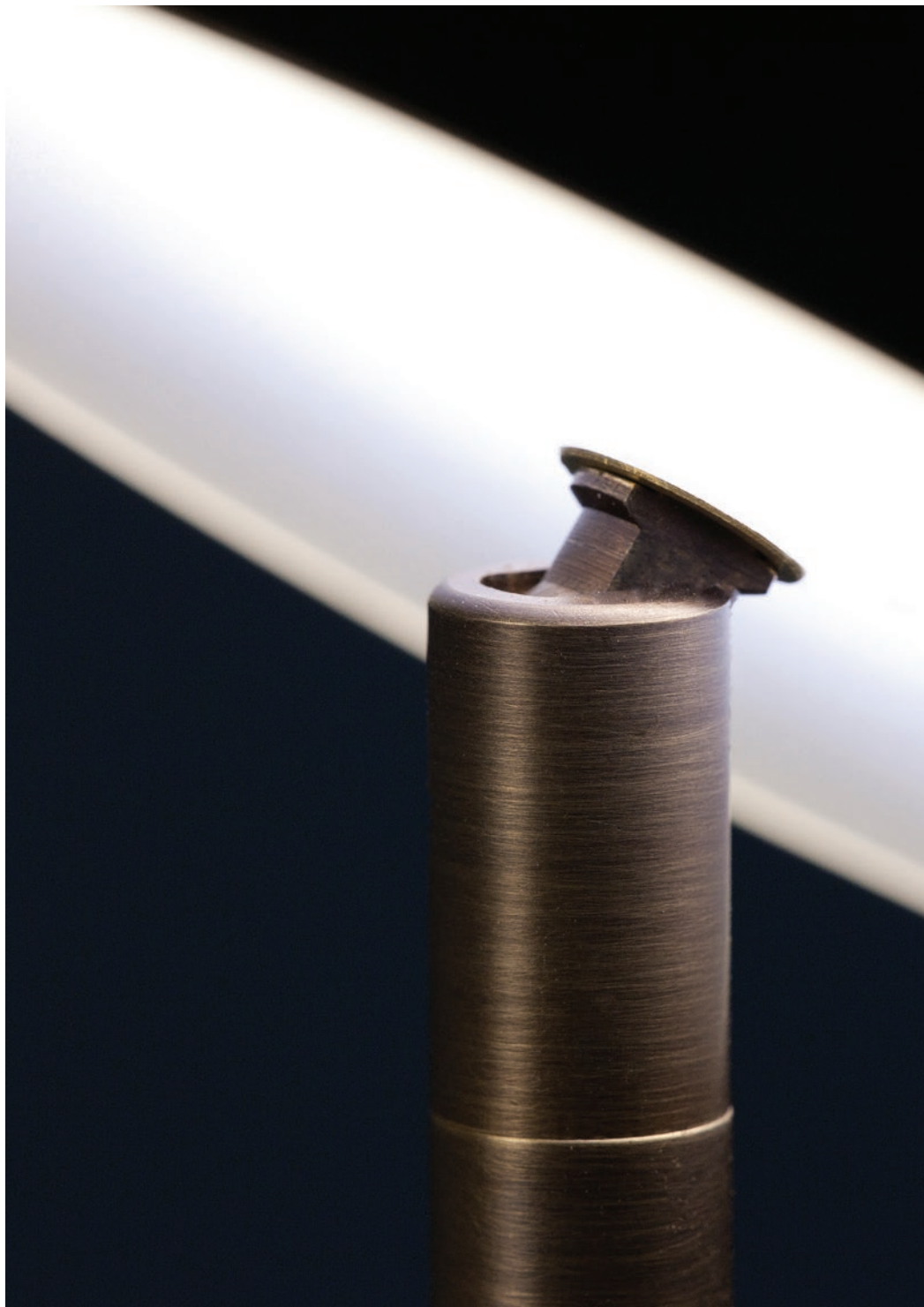





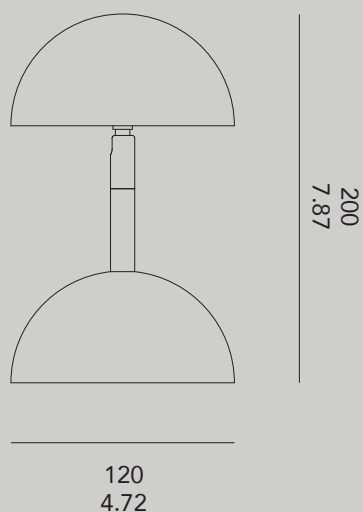

°diabolo



DBL.WH.30	white - 3000K LED
DBL.BK.30	black - 3000K LED
DBL.BRZ.30	bronze - 3000K LED
DBL.BRS.30	brass - 3000K LED
DBL.RAL.30	other RAL colors - 3000K LED
DBL.TBL.WH.30	table model - white - 3000K LED
DBL.TBL.BK.30	table model - black - 3000K LED
DBL.TBL.BRZ.30	table model - bronze - 3000K LED
DBL.TBL.BRS.30	table model - brass - 3000K LED
DBL.TBL.RAL.30	table model - other RAL colors - 3000K LED
DBL.WH.27	white - 2700K LED
DBL.BK.27	black - 2700K LED
DBL.BRZ.27	bronze - 2700K LED
DBL.BRS.27	brass - 2700K LED
DBL.RAL.27	other RAL colors - 2700K LED
DBL.TBL.WH.27	table model - white - 2700K LED
DBL.TBL.BK.27	table model - black - 2700K LED
DBL.TBL.BRZ.27	table model - bronze - 2700K LED
DBL.TBL.BRS.27	table model - brass - 2700K LED
DBL.TBL.RAL.27	table model - other RAL colors - 2700K LED

°xl(amp)

This lamp was initially designed to mark the edge of a fair booth and simultaneously present images on the inside. The lamp shade foil is foldable. This allows for easy transport and makes it possible to cover the lamp with a photo film. The lamp, by virtue of its size, defines its own space.

Design by Bart Lens









Foyer Universum Bremen



Office Nulens, Belgium - architect Lens°ass - photograph by Philippe van Gelooven







Kitchen concept Obumex - architect Lens°ass

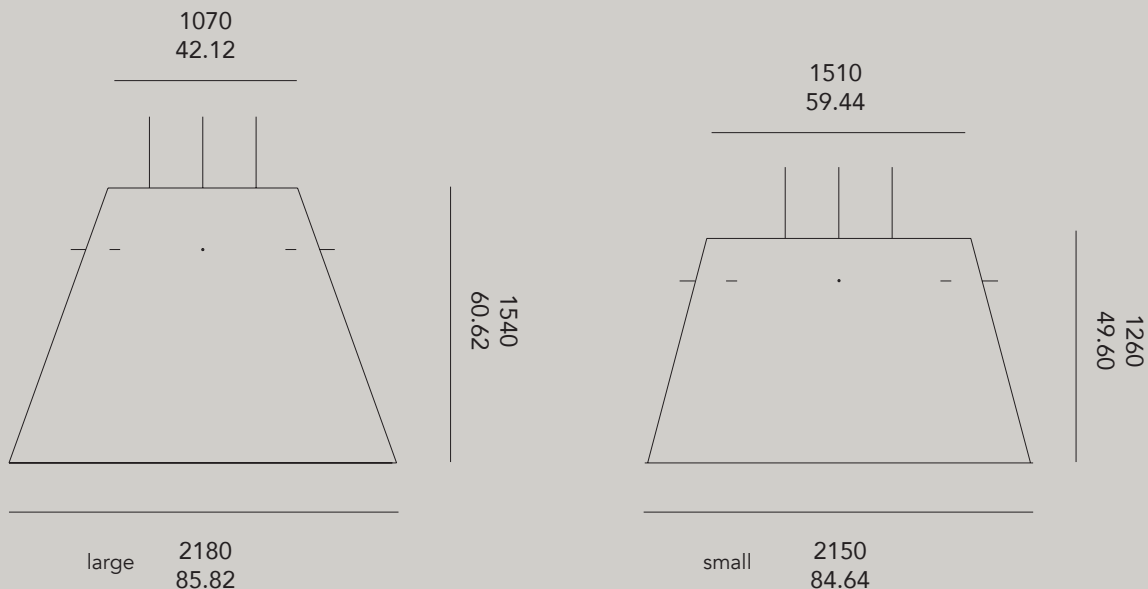

°xl(amp) large



XL.154.000	Xlamp h154 - 1 x E27 - excl lamp
XL.154.RGB.M	Xlamp h154 - 1 x E27 socket + RGB LED Master with remote control - excl lamp
XL.154.RGB.S	Xlamp h154 - 1 x E27 socket + RGB LED slave - excl lamp
XL.154.RGB.DMX	Xlamp h154 - 1 x E27 socket + RGB LED DMX controllable - excl lamp
XL.154.RGB.DAL	Xlamp h154 - 1 x E27 socket + RGB LED DALI controllable - excl lamp

°xl(amp) small



XL.126.000	Xlamp h126 - 1 x E27 - excl lamp
XL.126.RGB.M	Xlamp h126 - 1 x E27 socket + RGB LED Master with remote control - excl lamp
XL.126.RGB.S	Xlamp h126 - 1 x E27 socket + RGB LED slave - excl lamp
XL.126.RGB.DMX	Xlamp h126 - 1 x E27 socket + RGB LED DMX controllable - excl lamp
XL.126.RGB.DAL	Xlamp h126 - 1 x E27 socket + RGB LED DALI controllable - excl lamp

material: polyester - weight: max 34kg / 1.200oz - included: 2m cable, ceiling rose, 3 suspension elements - 230VAC - max 1000W



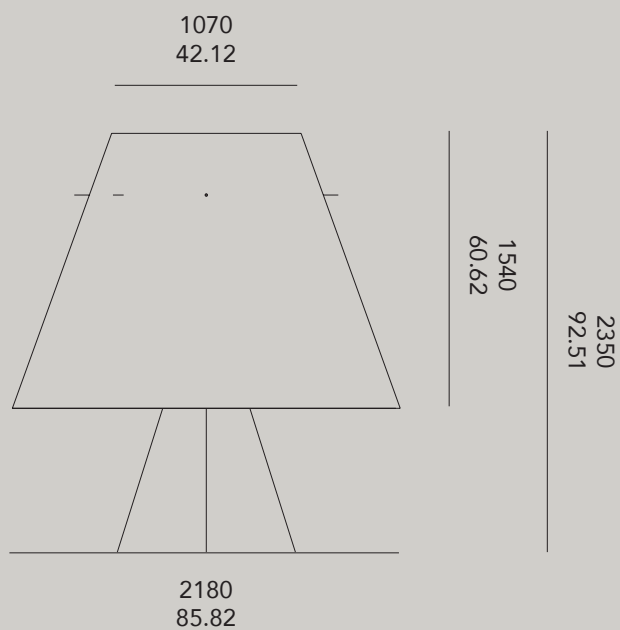

°xl(amp) floor

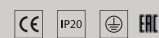

XL.154.127.FLR

1xE27 socket floor - excl lamp

material: polyester & steel - weight 36 kg / 1270 oz - included: 2m cable - 230VAC - max 1000W

°i-light

i-light is a thin, hanging tubular light fixture with an incorporated LED-light. The small loose-hanging chrome-plated sphere creates an unusual light and shadow play. The lamp can be used as trim lights, hanging lights, or – when several are combined – as a chandelier. When the tubes are hung low, the reflection of the chrome-plated rods produces a ‘starry sky effect’.

Design by Bart Lens











°i-light

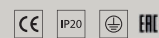

IL

i-light, 2700K

material: chromed brass - weight: 1,4 kg / 50 oz - included: 2 m cable & ceiling rose - 24VDC - max. 2W - excl. power supply

°tablecloth

A synthetic drape forms a covered table and at the same time a table structure. Entirely resembling a starched hail blank tablecloth, but manufactured in self-supporting blank plastic. Optionally, rechargeable light modules are available so that the tables can be placed wireless everywhere. After seven hours the tables announce the end of the party. Time to recharge!

Design by Bart Lens











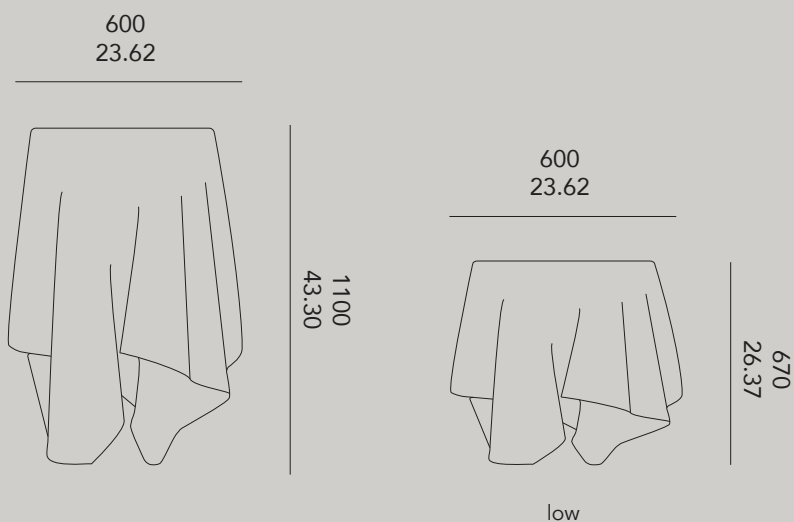

°tablecloth

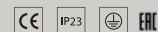

TCL.000	tablecloth
TCL.127	tablecloth 1 x E27 socket + 2 m cable - excl lamp
TCL.LED.B	tablecloth with white LEDs + battery-charger
TCL.RGB.B	tablecloth with RGB LEDs + battery-charger + remote control
TCL.RGB.C	tablecloth with RGB LEDs + cable + remote control
TCL.RGB.DMX	tablecloth with RGB LEDs, DMX controllable
TCL.TR.000	tablecloth transparant

°tablecloth low

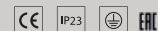

TCL.L.000	tablecloth low
TCL.L.127	tablecloth low 1 x E27 socket + 2m cable - excl lamp
TCL.L.LED.B	tablecloth low with white LEDs + battery-charger
TCL.L.RGB.B	tablecloth low with RGB LEDs + battery-charger + remote control
TCL.L.RGB.C	tablecloth low with RGB LEDs + cable + remote control
TCL.L.RGB.DMX	tablecloth low with RGB LEDs, DMX controllable
TCL.L.TR.000	tablecloth low transparant

material: PMMA - weight: 23,5 kg / 811 oz - 230VAC - max. 100W

°SO1

The design of this large-scaled lamp is pure and back to basic, therefore the SO1 really leaves nobody untouched. Made in PE (polyethylene) by rotational moulding, this large lamp (height 1m40) can be used inside as well as outside.

Built-in into ceiling or wall, lying on the floor or just hanging in the room.

Outside used as street light (with a post) or as lighting accent in the garden.

The use of this lighting-object will give an extra accent to rooms, spaces, streets and public parks.

Design by Sara Olaerts

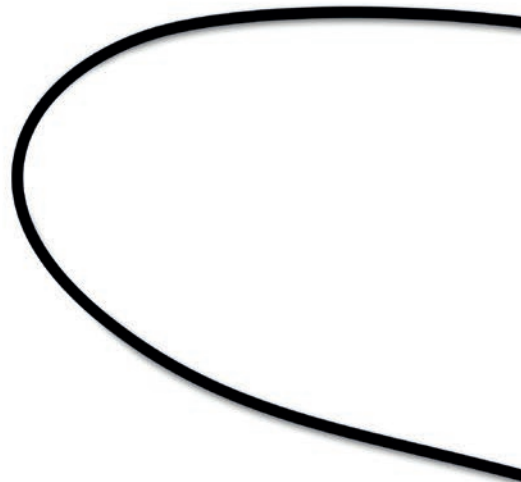





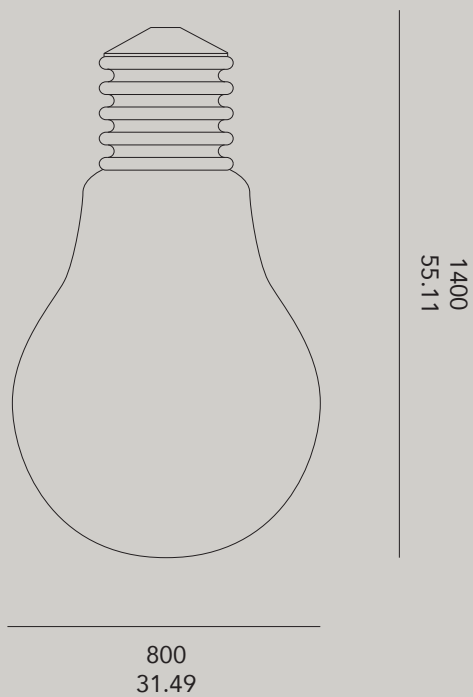

°so1



SO1.155.000	SO 1 - 1 x PL55W
SO1.155.US	SO 1 - 1 x PL55W - 110VAC
SO1.155.DAL	SO 1 - 1 x PL55W DALI controllable
SO1.RGB.DMX	SO 1 RGB LED DMX controllable
SO1.RGB.DAL	SO 1 RGB LED DALI controllable
SO1.RGB.M	SO 1 RGB LED master with remote control
SO1.RGB.S	SO 1 RGB LED slave

materials: PE & steel - weight: 18kg / 635oz - 230VAC or 110VAC - max 55W



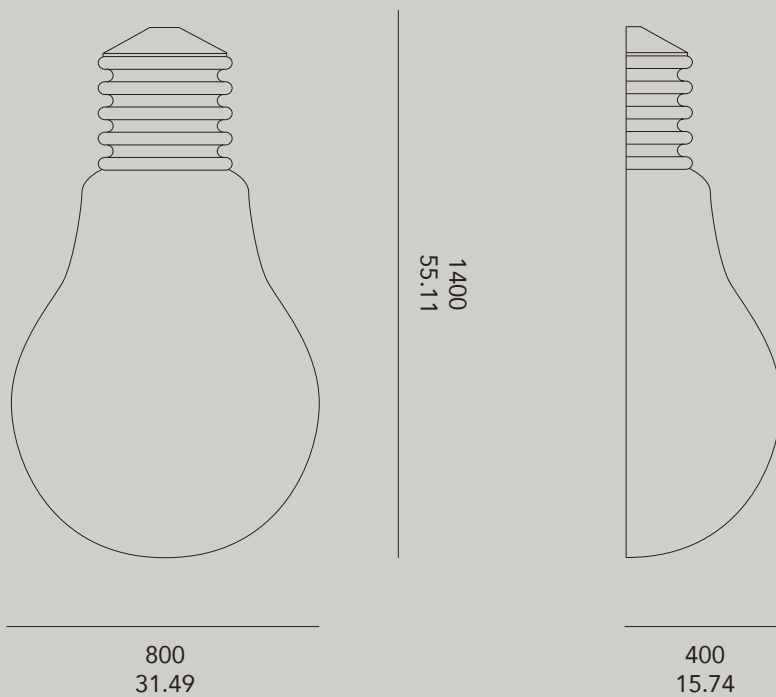

°1/2 so1



SO1.155.1/2	1/2 SO 1 with 1 x PL55W
SO1.155.1/2.US	1/2 SO 1 with 1 x PL55W - 110VAC
SO1.155.1/2.DAL	1/2 SO 1 with 1 x PL55W DALI controllable

materials: PE & steel - weight: 10kg / 353oz - 230VAC or 110VAC - max 55W - outdoor use on request

°poirot

Curled as a curly moustache, is the corpus of the light element, called “Poirot”, with whom this moustache is associated the best. Available as hanging lamp or two types of wall lamp and in several colors. With a lumen output of over 2500lm for the wall version and over 7000lm for the hanging version, the Poirot is perfect for situations where a lot of light is required.

Design by Bart Lens

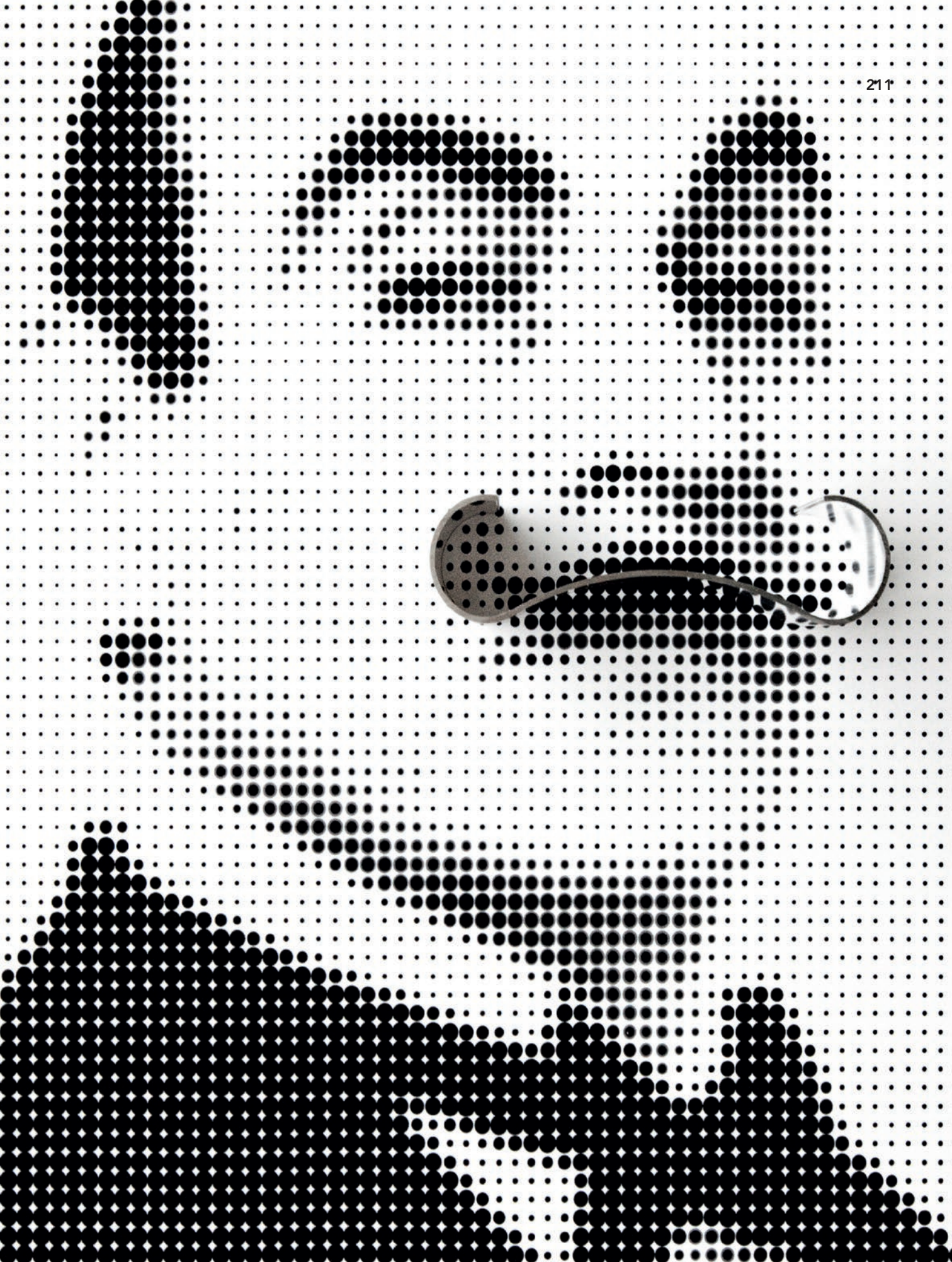









POIROT



652
25.66

MAGNETIC
POIROT

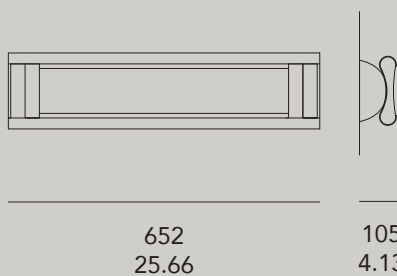

652
25.66

105
4.13

PENDANT
POIROT

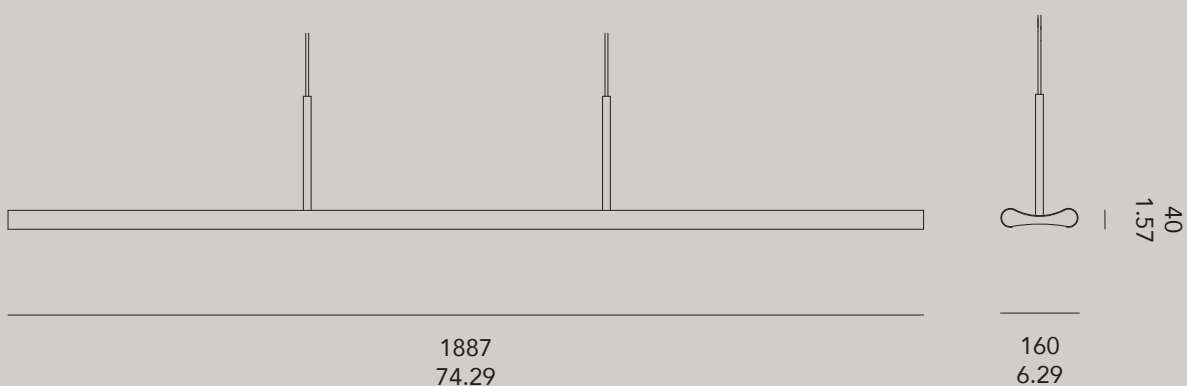

°poirot



PRT.WH.30	white
PRT.RAL.30	other RAL colors
PRT.MG.WH.30	magnetic wall version - white - incl. wall bracket
PRT.MG.RAL.30	magnetic wall version, custom RAL color, incl. wall bracket
PRT.PD.WH.30	pendant version - white
PRT.PD.RAL.30	pendant version - custom RAL color

material: painted aluminium - single: 1,4 kg - 50 oz / 16W - 1140lm - pendant: 4,3 kg - 152 oz / 102W - 4320lm
230VAC - 3000K LED tube T8

°de light ful

°de light ful is a hanging tubular light fixture with integrated LED light. With a light source on top and bottom, you can create your own atmosphere. The use of this lighting-object will give an extra dimension to your room. You can choose for a version with solid colors or for a version with dynamic colors controllable by DMX. The RGBW LEDs give you the opportunity to choose any desired color.

Design by Eden Design







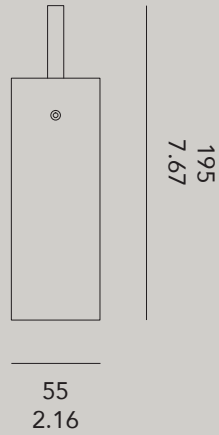

DLF55.C.D.T.B		de light ful fixture - 100 mm	   
Color body	BK WH	black matt ral 9011 white matt ral 9016	
Diffuser	F O10 O20 O30 O40	frosted 10° optic 20° optic 30° optic 40° optic	
Top led	WW2	3000K 800 lm	
Bottom led	WW2 R G B Y M C RGBW	3000K 800 lm red green blue yellow magenta cyan five channel DMX - RGBW	

material: painted aluminium - weight: 350 gr / 12,3 oz - 24VDC - max 18W for WHI/CLR, max 15W for DMX version

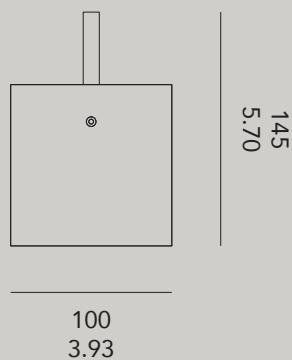

DLF100.C.T.B		de light ful fixture - 100 mm - frosted diffusers	   
Color body	BK WH	black matt ral 9011 white matt ral 9016	
Top led	WW2	3000K 800 lm	
Bottom led	WW2 R G B Y M C RGBW	3000K red green blue yellow magenta cyan five channel DMX - RGBW	

Accessories

PS.24.16	power supply 24DVC 16W for powering one fixture (WHI/CLR version) 2 pieces required: each led one driver
PS.24.XXX	power supply 24DVC ...W for powering several fixtures (see page 76)
DLF.ADR.XXX	pre-programmed DMX address
DLF.ROSE.W	rose ceiling white, diameter 50 mm
DLF.ROSE.B	rose ceiling black, diameter 50 mm



material: painted aluminium - weight: 450 gr / 15,9 oz - 24VDC - max. 18W for WHI/CLR, max 22W for DMX version

Product photography & photo editing /
Philippe Van Gelooven & etremoderne.be

Graphic design /etremoderne.be

Paper / FSC-C007342 en PEFC certified

First edition

© Eden Design, 2017, Genk, Belgium