

ARCHITONIC GUIDE

HEIMTEXTIL

FRANKFURT

2018

09-12 JANUARY

Der Architonic Guide möchte Ihnen Orientierung geben und dabei helfen, die besten Aussteller schnell zu finden. Die Auswahl von Architonic ist rein redaktionell und beschränkt sich auf Premium-Hersteller von Produkten, die für die Gestaltung von Gebäuden und Räumen relevant sind. Ein Guide von Architekten für Architekten.

The Architonic Guide allows you to find the best exhibitors quickly. Architonic's selection is purely an editorial one and is limited to high-end manufacturers whose products are relevant to the design of buildings and spaces. It's a guide by architects for architects.

ARCHITONIC.COM

# OVERVIEW PLAN

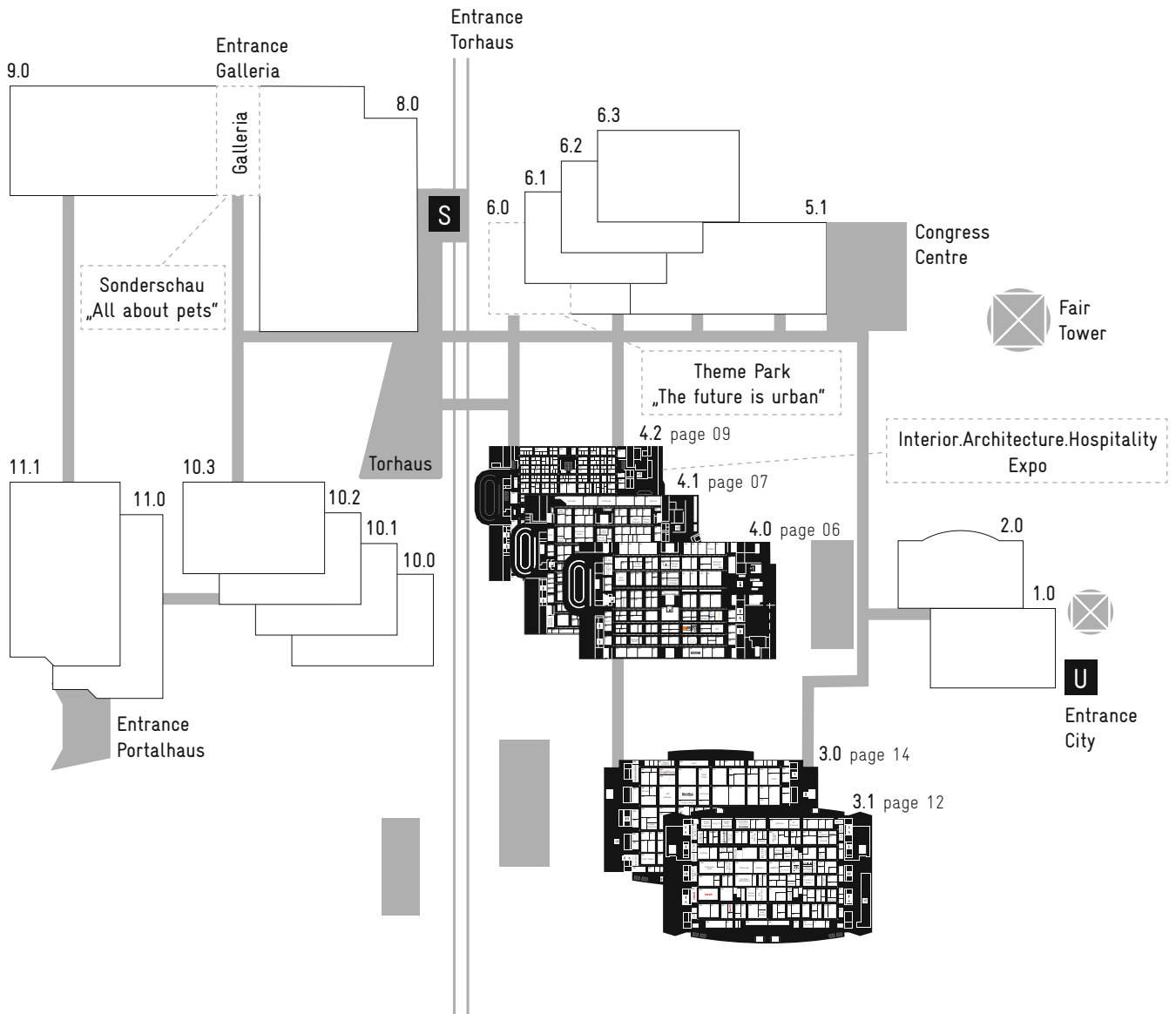

DIE INTERIOR.ARCHITECTURE.HOSPITALITY EXPO IST EIN NEUES AUSSTELLUNGSFORMAT SPEZIELL FÜR ARCHITEKTEN, INNENARCHITEKTEN UND HOTELAUSSTATTER. HIER WERDEN TEXTILE PRODUKT-LÖSUNGEN UND INNOVATIONEN VORGESTELLT. NETWORKEN KANN MAN IM INTERIOR.ARCHITECTURE.HOSPITALITY SALON, HIER IST AUCH DER STARTPUNKT DER MESSEFÜHRUNGEN UND IM BEREICH INTERIOR.ARCHITECTURE.HOSPITALITY LECTURE GIBT ES EIN VORTRAGSPROGRAMM SPEZIELL FÜR ARCHITEKTEN, INNENARCHITEKTEN UND HOTELIERS.

INFO

Published by

Architonic AG | Müllerstrasse 71 | 8004 Zurich | Switzerland  
T +41 44 297 20 20 | info@architonic.com | architonic.com

Partner

heimtextil  messe frankfurt

hall stand page			hall stand page			hall stand page			hall stand page		
<b>A</b>			<b>E</b>			<b>K</b>			Prodital 3.0 F61 14		
Adfors	3.1 A02	12	Ehrlich-Leder	3.0 D30	14	Kets Tekstil	4.0 C70	06	<b>R</b>		
Agena	3.1 A92B	12	Eijffinger	3.1 C90	12	Kobe	3.1 B81	12	Rahmig & Partner 3.0 B90 14		
Alfatex	4.0 E24	06	Elitis	3.1 C50	12	KT Exclusive	3.1 A30	12	Rasch 3.1 E91 E93 12		
Alhambra Int.	3.1 B90	12	Elvin Tekstil	3.0 E81	12	Kücükerler Tekstil	4.1 B71	07	Rasch at Rawena 3.1 F81 12		
Alonso Mercader	4.1 C54	07	Engblad & Co	3.1 A70	12	L			Rekor Dokuma 4.1 B20 07		
Apelt Stoffe	3.0 B50	14	Equipo Drt	3.1 B82	12	L'Albero Della C.	3.1 A90	12	Röwa GAL1 N19		
Architects Paper	3.1 C91A D92	12	Erfal	5.1 C76		Lavmi	3.1 B04	12	<b>S</b>		
Architects Paper	6.0 B16		Erteks	4.0 A20	06	Lenzing	8.0 H65		Sabine Röhse 4.2 A24 09		
Arte	3.1 D40	12	Evimteks	4.1 A86	07	Libeco Lagae	4.0 C41	06	Sander 11.0 B71		
Arthouse	3.1 A42	12	EVO Interior Fabrics	3.1 B91	12	Limonta	3.1 B16	12	Santorus 3.1 F10 12		
Asanteks	4.1 G71	07	<b>F</b>			Lincrusta	3.1 G21	12	Saum & Viebahn 3.0 A65 14		
Ashley Wilde	4.1 F57	07	Fardis	3.1 D18	12	Linder	3.0 B10	14	Schlossberg 11.1 C71		
Associated Weavers	3.0 F41	14	Fargotex	4.1 G62	07	Loro Piana	4.1 B53	07	Sedacor 3.1 B50 12		
Athenea	4.1 D15	07	Feathr	3.1 A11	12	Loymina	3.1 F32	12	Sioen Nordifa 3.1 G50 12		
ATN	4.0 E15	06	Fidivi	4.2 H71	09	<b>M</b>			Skinwall 3.1 C92 12		
<b>B</b>			Findeisen	4.2 J71	09	Maasberg	4.2 X15	09	Spradling 4.0 E31 06		
Berengier	4.1 F26	07	Flocart	3.1 D15	12	Manuel Revert	4.1 B14	07	<b>T</b>		
Berteks Pazarlama	4.1 J90	07	Flukso	4.0 B48	06	Marburger	3.1 C70 D70	12	Ta Li 4.0 D19 06		
Bezmez Tekstil	4.0 B40	06	Flurstück	4.2 J71	09	Marcal	5.1 B61		Texdecor 3.1 A51 C51 12		
Billerbeck	11.1 C70		Foresti H. Collection	3.1 A92A	12	Marteks Tekstil	4.0 F65	06	Thesign 4.2 H71 09		
Boråstapeter	3.1 A70	12	Forster Rohner	4.2 X03	09	Mehgies	4.2 X08	09	Thevenon 4.1 E15 07		
Byron & Byron	5.1 B36		Fouta	11.1 D79		MHZ Hachtel	5.1 B70		Tissage Mahieu 3.1 B35 12		
<b>C</b>			Futura Leathers	3.0 A68	14	MI-Millennium	4.0 F31	06	Toucan-T 4.2 J71 09		
Calcutta	3.1 D18	12	<b>G</b>			Montbel	3.0 B55	14	Tretford 4.2 J71 09		
Casalegno Tendaggi	4.0 C40	06	G-Tex Stainless	4.0 B60	06	Moon	4.1 F40	07	<b>V</b>		
Castilla	4.1 A06	07	Gebr. Munzert	4.1 A87	07	Morton, Young & B.	4.1 G56	07	Vamvax 3.0 B81 14		
Chieftain	4.2 X05	09	Germania	3.0 B51	14	Mr Perswall	3.1 A70	12	Vanelli 4.1 D14B 07		
Clarke & Clarke	3.1 B80	12	Gerriets	4.2 X10	09	Muraspec	3.1 D18	12	Vasco 4.0 E80 06		
Cole & Son	3.1 A70		Graham & Brown	3.1 E20	12	<b>N</b>			Vescom 3.1 B33 12		
Comersan	4.1 A50	07	Grandeco	3.1 D71	12	Newmor	3.1 E34	12	Vorwerk 4.2 J71 09		
Continental	4.0 D15	06	Gruppo Mastrotto	3.0 D82	14	NLXL	3.1 C30	12	<b>W</b>		
Coordonne	3.1 B31	12	Gustav Gerster	3.0 D41	14	Nobilis	3.1 C21	12	Welter 3.1 A06 12		
Crevin	4.0 E35	06	Guy Masureel	3.1 B60	12	<b>O</b>			Wise Floor 3.1 B85 12		
<b>D</b>			<b>H</b>			Object Carpet	4.2 J71	09	<b>Y</b>		
Drapilux	3.0 C61	14	Heco	3.0 A50	14	Omexco	3.1 D36	12	Yakar Tekstil 4.1 C86 07		
Drapilux	4.2 X01	09	Hohenberger	3.1 C17	12	On-Em Tekstil	4.0 A81	06	York Wallcovering 3.1 E51 E54 12		
Decobel	3.1 B92	12	Hollandfelt	3.0 E91	14	Orac	3.1 C36	12	Yoyo Designs 3.1 C16 12		
Dekoma	4.0 G35	06	<b>I</b>			Organoid	3.1 A15	12	<b>Z</b>		
Deltracon	4.0 C67	06	Indes Fuggerhaus	3.1 C91B	12	Oriental Carpet	3.0 C55	14	Zimmer + Rohde 3.1 D32 12		
Desima German	3.1 D37	12	Iris Maschek	4.2 G08	09	<b>P</b>					
Dev Tekstil D. Yapi	4.0 B80	06	<b>J</b>			Penelope Dokuma	4.0 B14A	06			
Diaz	4.1 B91	07	JAB Anstoetz	3.0 B71	14	Pintail	3.0 D34	14			
Dina Vanelli Tekstil	4.1 D14A	07	Joop! Living	11.0 B60-B61		Pintail	4.2 J45	09			
DWC	3.1 G92	12	Joop! Living	3.0 C54	14	Prestigious Textiles	3.1 B40	12			

This list was printed on 22nd November 2017.  
We sincerely apologise if we have omitted or misplaced any top-quality manufacturers.

**FACTS AND INSPIRATIONS**

**NEUE GENERATION AN BAHNENWARE UND SL-FLIESEN. 88 QUALITÄTEN. 1.200 FARBEN. FREI VON BITUMEN, LATEX, PVC UND GESUNDHEITSSCHÄDLICHEN EMISSIONEN. LERNEN SIE DIE NEUE KOLLEKTION KENNEN.**

**OBJECT CARPET**  
Halle 4.2, Stand J71



GET TRUSTED PRODUCT INFORMATION  
AND THE BEST DEALS DIRECTLY FROM  
PREMIUM BRANDS AND RETAILERS

Architonic is the world's leading research tool for the specification of premium architectural and design products. Our curated database currently provides information about more than 300,000 products from 1,500 brands and 11,500

designers. 16 million architects, interior designers and design enthusiasts annually choose Architonic as their guide to the very best.

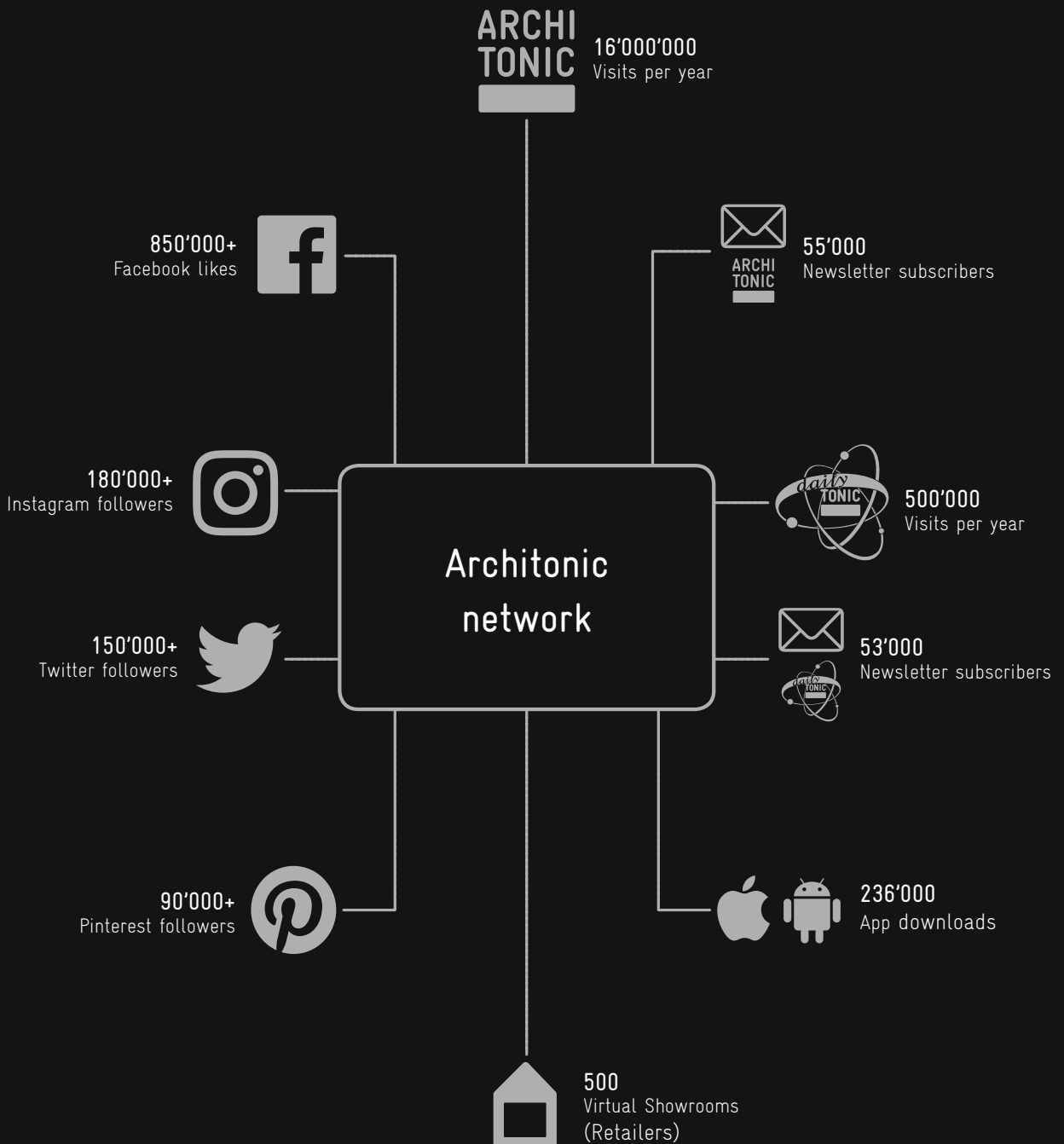

# ARCHITONIC MATERIAL TENDENCIES: INTERVIEW FÄRG & BLANCHE



FÄRG & BLANCHE AT WORK

Fredrik Färg and Emma Marga Blanche like to combine industrial production and exclusive handcraft. The works of the Swedish–French design duo often have a tailored yet playful, touch – showing that their experiments, in particular with textiles, could be applied to mass production. Architonic met Färg & Blanche and discussed their hands-on experimentations with materials.

If you had to restrict yourself to working with just one material for the next three years, which would you choose? Textiles. Because there is a lot of innovation happening. You can go from being flat to having volume – you cut, you shape, you tailor, you construct. You can also make self-supportive structures today. It is fascinating in every way.

What project first comes to your mind that involves textiles being proceeded in an unusual context?

I think it would be the Emma Armchair for Gärsnäs. It is a hand-sewn, well-tailored armchair that speaks the language of craftsmanship, picking up the gauntlet. Our idea was to stitch right through the backrest of the armchair. There is no wood or metal frame in the backrest, only a textile composition. The material for the backrest is piled up in layers and then sewn together in one move

with a sewing machine. It is an effective production, but takes a very skilled craftsman to make this chair.

Is there a material with which you don't have quite so much experience but would like to explore a bit further? We're always curious about new materials. We have little experience with ceramics and would love to develop further in this field. Also glass would be a wonderful material to work with, which we haven't so far. As for textiles, we've noted a large development in 3D knitting – everything from shoes and clothes to furniture. For future projects, we have been experimenting with natural fibre, for example linen and hemp. We think that textile or fibre material will be seen in a range of appliances. You can already see this happening in the car industry.

*Architonic continuously gathers opinions from renowned designers and industry leaders who share their experience when it comes to material choices, helping us all gain a more complete picture of the current scene and better predict what lays ahead. Their reflections provide the basis of our ongoing series Material Tendencies which is part of our Architonic Trend Analysis program. For more interviews with exclusive insights:*

*<http://bit.ly/2osmhKd>*



EMMA FOR GÄRSNÄS



COUTURE FOR BD BARCELONA



FLY F-A-B (SPECIAL EDITION) FOR CLÉMENT ADER

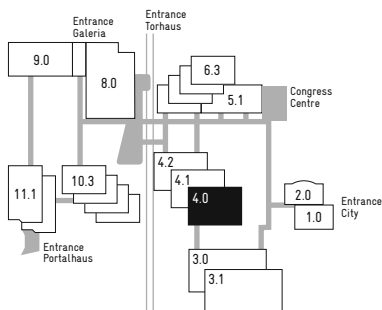

NOTES

.....

.....

.....

.....

.....

.....

.....

.....

HALL 4.0

UPHOLSTERY  
WINDOW  
FLOOR

HALL 4.0

Alfatex	E24	Dev Tekstil Dericiogullari Yapı	B80	On-Em Tekstil	A81
ATN	E15	Erteks	A20	Penelope Dokuma	B14A
Bezmez Tekstil	B40	Flukso	B48	Spradling	E31
Casalegno Tendaggi	C40	G-Tex Stainless	B60	Ta Li	D19
Continental	D15	Kets Tekstil	C70	Vasco	E80
Crevin	E35	Libeco Lagae	C41		
Dekoma	G35	Marteks Tekstil	F65		
Deltracon	C67	MI-Millennium	F31		

This list was printed on 22nd November 2017. We sincerely apologise if we have omitted or misplaced any top-quality manufacturers.

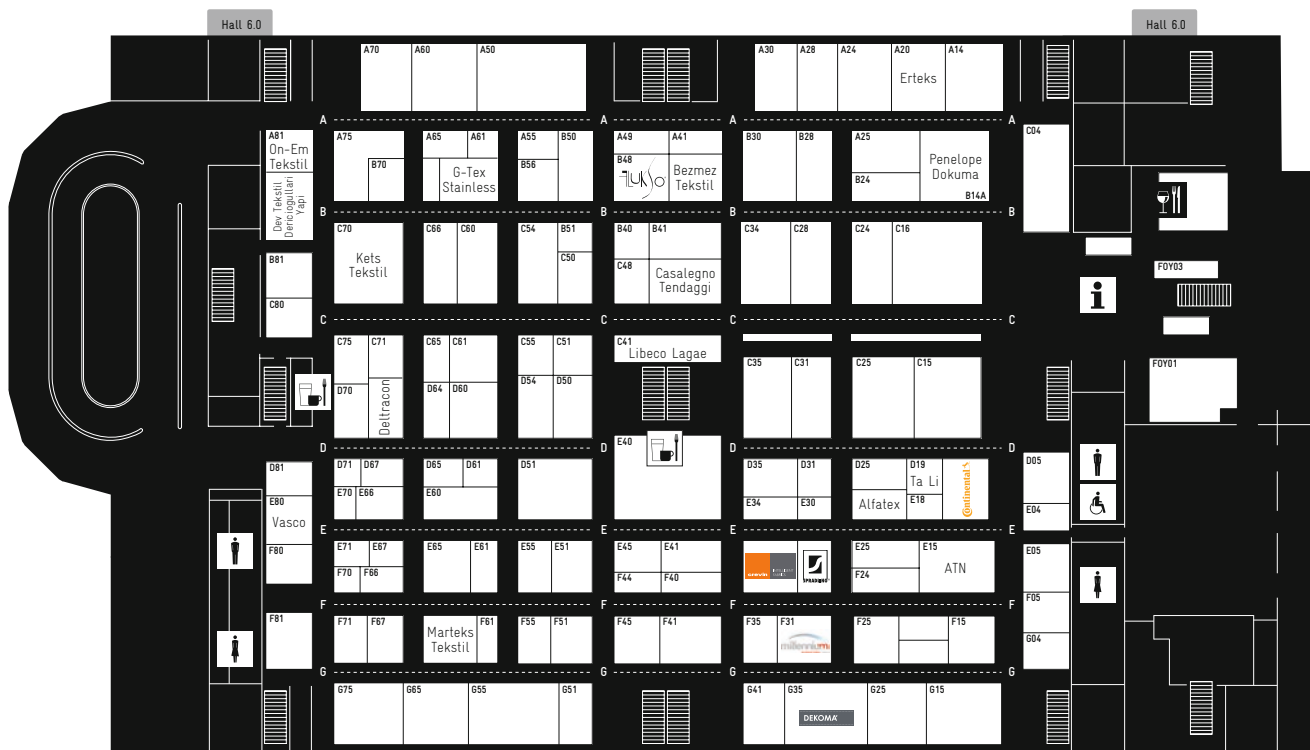

**Continental**  
The Future in Motion

**Benecke-Hornschuch**  
Surface Group

skal® Digital Print Collection  
Individualization is key.  
See us in Hall 4.0, Stand D15.

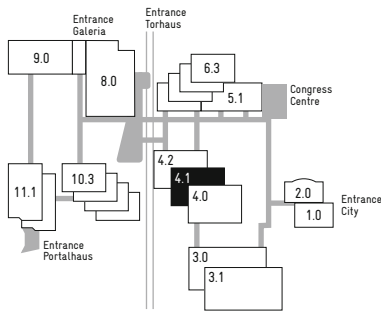

NOTES

.....

.....

.....

.....

.....

.....

.....

HALL 4.1

UPHOLSTERY  
WINDOW

HALL 4.1

Alonso Mercader	C54	Diaz	B91	Moon	F40
Asanteks	G71	Dina Vanelli Tekstil	D14A	Morton, Young & Borland	G56
Ashley Wilde	F57	Evimteks	A86	Rekor Dokuma	B20
Athenea	D15	Fargotex	G62	Thevenon	E15
Berengier	F26	Gebr. Munzert	A87	Vanelli	D14B
Berteks Pazarlama	J90	Küçükler Tekstil	B71	Yakar Tekstil	C86
Castilla	A06	Loro Piana	B53		
Comersan	A50	Manuel Revert	B14		

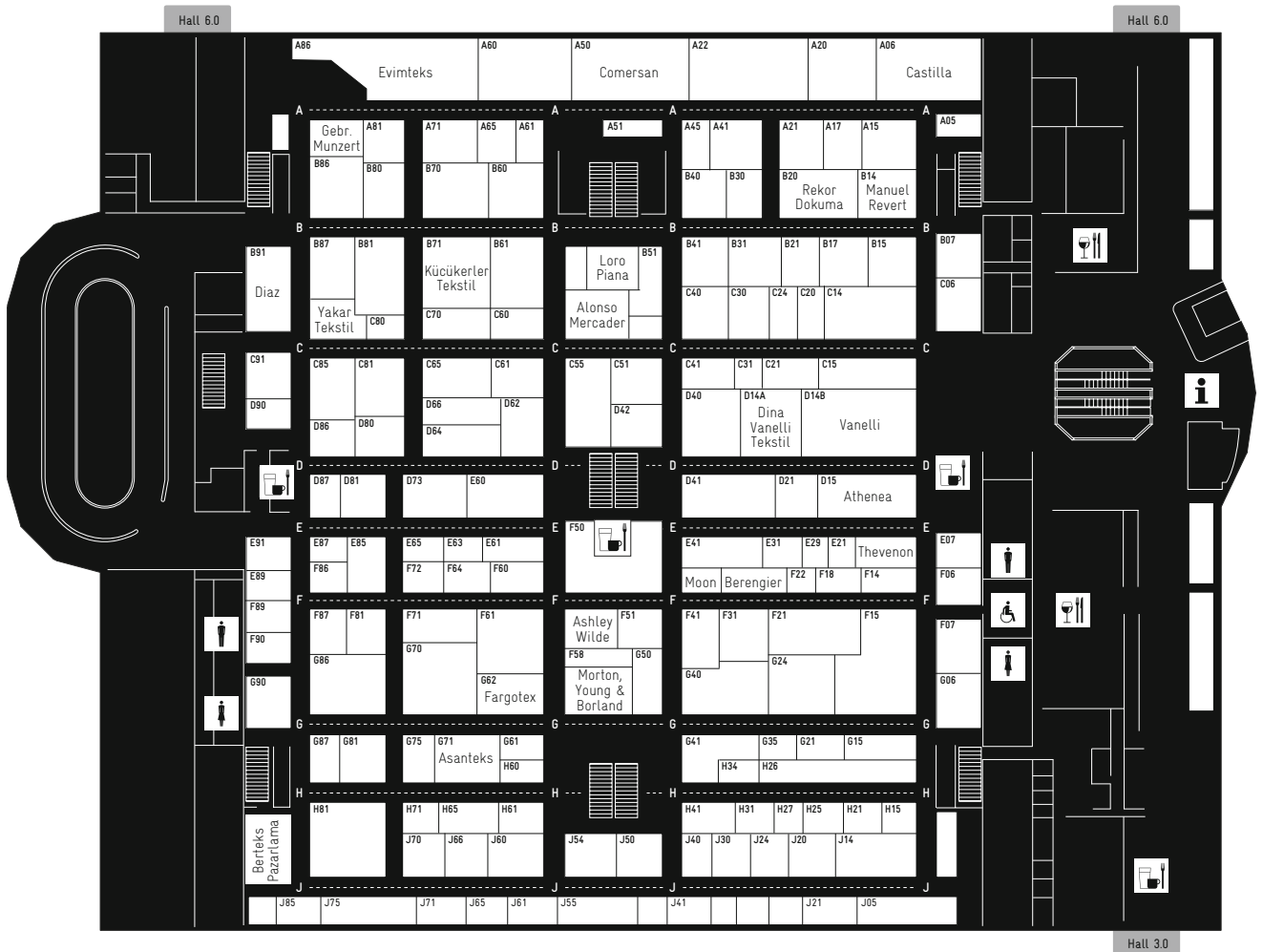

THANK YOU!

15 YEARS ARCHITONIC



ARCHITONIC.COM



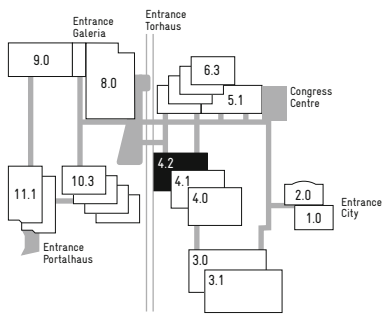

NOTES

.....  
 .....  
 .....  
 .....  
 .....  
 .....  
 .....

HALL 4.2

TEXTILE DESIGN  
 TECHNICS  
 UPHOLSTERY  
 WINDOW  
 FLOOR  
 NEW: EXPO

HALL 4.2

Chieftain	X05	Iris Maschek	G08	Toucan-T	J71
Drapilux	X01	Maasberg	X15	Tretford	J71
Fidivi	H71	Mehgies	X08	Vorwerk	J71
Findeisen	J71	Object Carpet	J71		
Flurstück	J71	Pintail	J45		
Forster Rohner	X03	Sabine Röhse	A24		
Gerriets	X10	Thesign	H71		

This list was printed on 22nd November 2017. We sincerely apologise if we have omitted or misplaced any top-quality manufacturers.

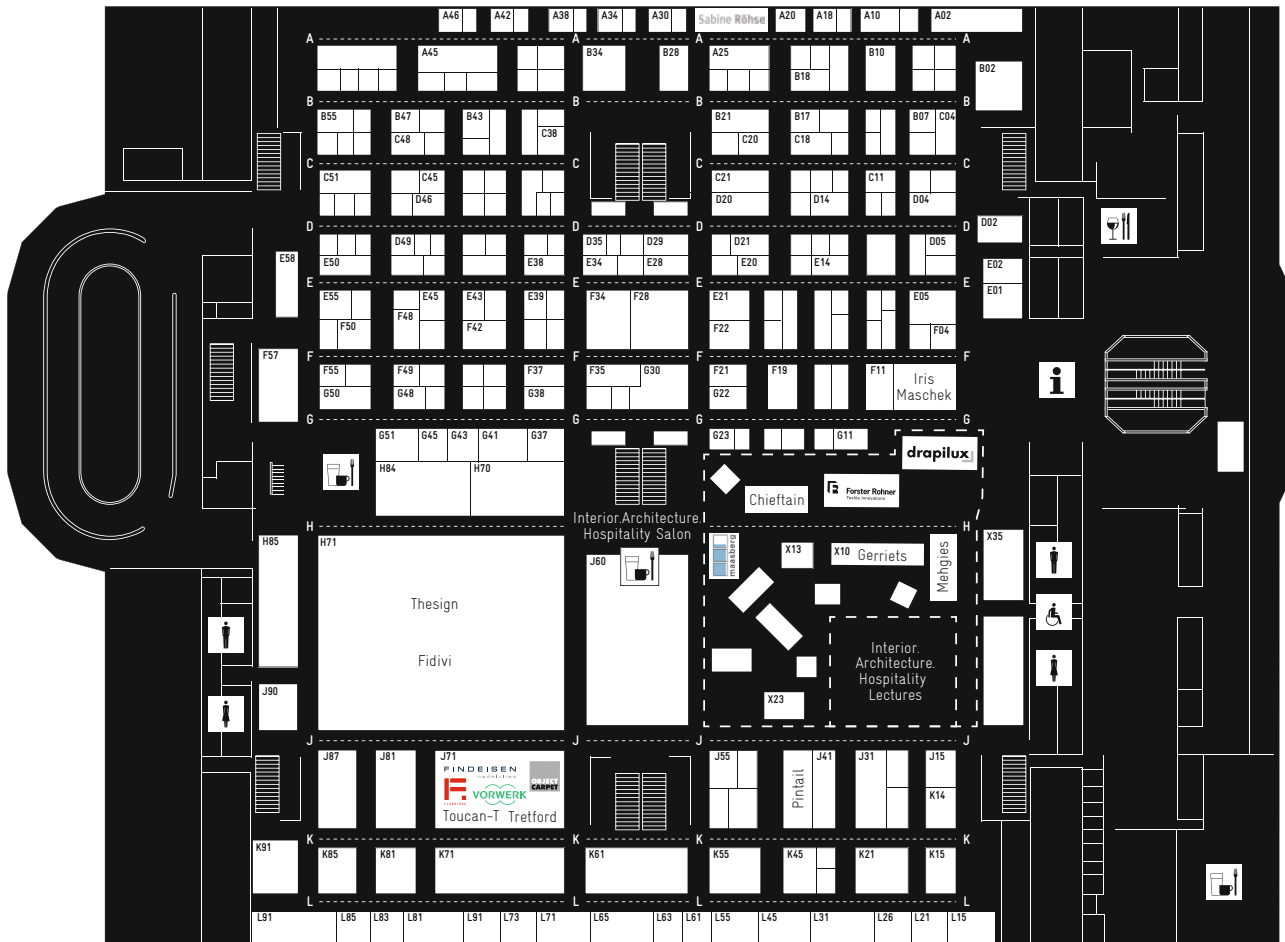

heimtextil

9. – 12. 1. 2018

**MAD ABOUT  
TEXTILES**





**NEW**  
in Hall 4.2

**EXPO**

Interior.Architecture.Hospitality

## TEXTILE SOLUTIONS FOR INTERIOR DESIGN, ARCHITECTURE AND HOTEL OUTFITTING.

Under the heading of **Interior.Architecture.Hospitality** around 400 of the 3,000 Heimtextil exhibitors will be showcasing their contract business portfolios. As a creative decision maker in the contract sector, you'll discover in Frankfurt a wealth of innovative new ideas, expert guided tours, inspirational lectures and trend presentations as well as the Expo – the new exhibition format for textile innovations and functional solutions for architects, interior designers and hotel outfitters.

**TICKETS NOW AT ADVANCE SALE PRICES:**  
[heimtextil.messefrankfurt.com](http://heimtextil.messefrankfurt.com)



**messe frankfurt**

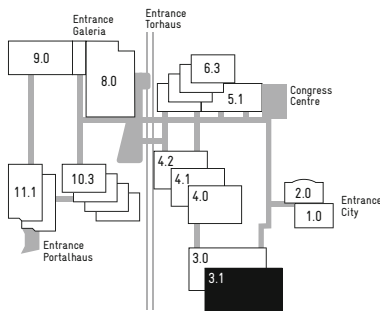

NOTES

.....

.....

.....

.....

.....

.....

.....

.....

ARE YOU AN ARCHITECT, DESIGNER OR ARCHITECTURAL PHOTOGRAPHER? WANT AN PROFILE ON ARCHITONIC? GET IN TOUCH WITH US!

[ARCHITONIC.COM/EN/APPLY](http://ARCHITONIC.COM/EN/APPLY)

INFO

HALL 3.1

Adfors	A02	Lavmi	B04
Agena	A92B	Limonta	B16
Alhambra Internacional	B90	Lincrusta	G21
Architects Paper	C91A-D92	Loymina	F32
Arte	D40	Marburger	C70-D70
Arthouse	A42	Mr Perswall	A70
Boråstapeter	A70	Muraspec	D18
Calcutta	D18	Newmor	E34
Clarke & Clarke	B80	NLXL	C30
Cole & Son	A70	Nobilis	C21
Coordonne	B31	Omexco	D36
Decobel	B92	Orac	C36
Desima German	D37	Organoid	A15
DWC	G92	Prestigious Textiles	B40
Eijfinger	C90	Rasch	E91-E93
Elitis	C50	Rasch at Ravena	F81
Engblad & Co	A70	Santorus	F10
Equipo Drt	B82	Sedacor	B50
EVO Interior Fabrics	B91	Sioen Nordifa	G50
Fardis	D18	Skinwall	C92
Feathr	A11	Texdecor	A51-C51
Flocart	D15	Tissage Mahieu	B35
Foresti Home Collection	A92A	Vescom	B33
Graham & Brown	E20	Welter	A06
Grandeco - Wallfashion	D71	Wise Floor	B85
Guy Masureel	B60	York Wallcovering	E51-E54
Hohenberger	C17	Yoyo Designs	C16
Indes Fuggerhaus	C91B	Zimmer + Rohde	D32
Kobe	B81		
KT Exclusive	A30		
L'Albero Della Cuccagna	A90		

This list was printed on 22nd November 2017. We sincerely apologise if we have omitted or misplaced any top-quality manufacturers.

**cover**

The world's leading source for carpets and textiles

@covermag2005
 @COVERMag2005
 COVERMag2005

WALL

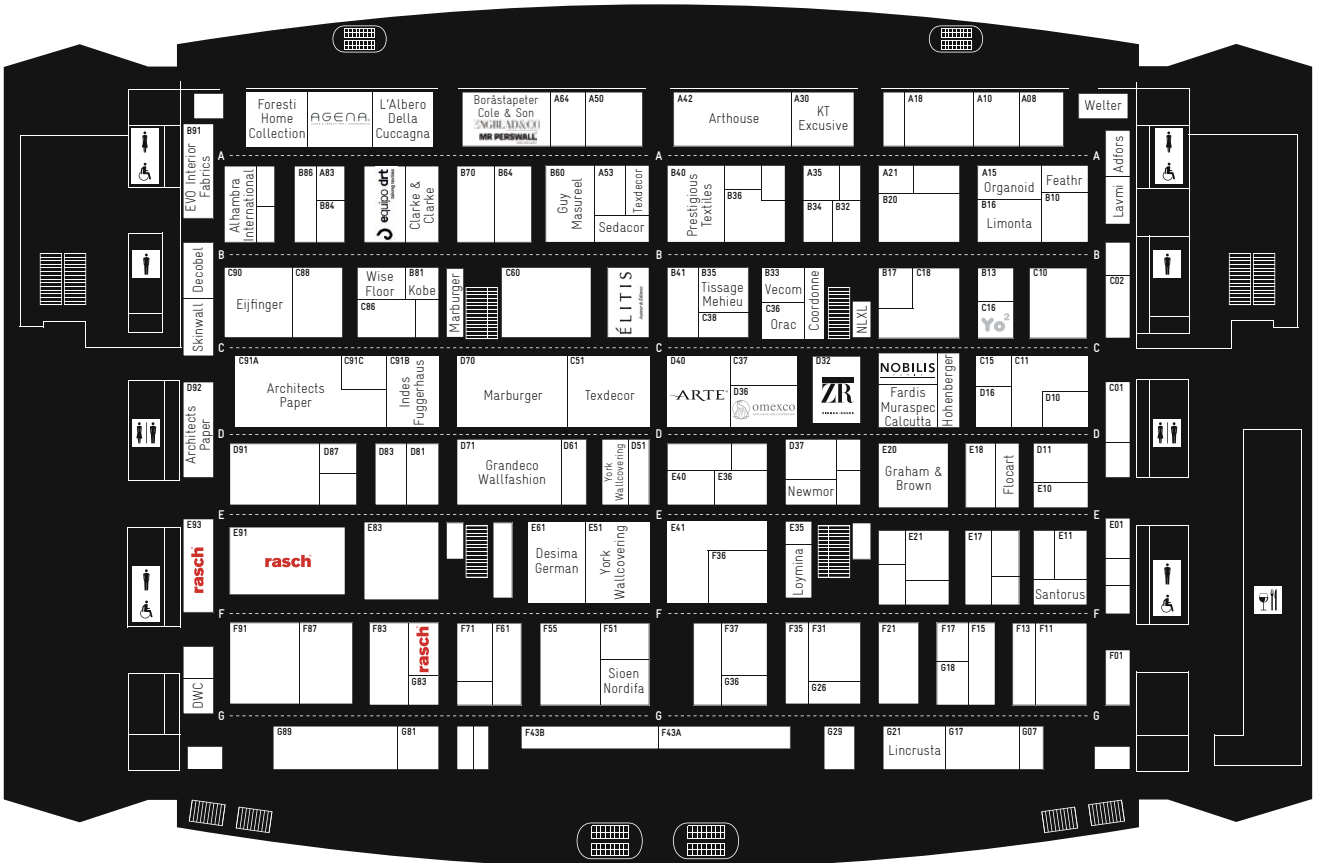

**HOME IMPROVEMENTS**

Develop yourself at Architonic

[JOBS.ARCHITONIC.COM](http://JOBS.ARCHITONIC.COM)

**ARCHITONIC**

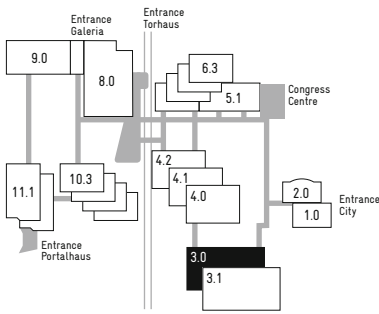

NOTES

.....

.....

.....

.....

.....

.....

.....

.....

THE ARCHITONIC NEWSLETTER KEEPS YOU UP TO SPEED, BRINGING YOU THE LATEST ON YOUR FAVOURITE SUBJECTS.

[ARCHITONIC.COM/SUBSCRIBE](http://ARCHITONIC.COM/SUBSCRIBE)

INFO

THE WORLD OF DESIGN TO GO!  
 DOWNLOAD FOR FREE YOUR FAVOURITE ARCHITONIC DESIGN APP.

[ARCHITONIC.COM/EN/APPS](http://ARCHITONIC.COM/EN/APPS)

INFO

HALL 3.0

Apelt Stoffe	B50
Associated Weavers	F41
Drapilux	C61
Ehrlich-Leder	D30
Elvin Tekstil	E81
Futura Leathers	A68
Germania	B51
Gruppo Mastrotto	D82
Gustav Gerster	D41
Heco	A50
Hollandfelt	E91
JAB Anstoetz	B71
Joop! Living	C54
Linder	B10
Montbel	B55
Oriental Carpet	C55
Pintail	D34
Prodital	F61
Rahmig & Partner	B90
Saum & Viebahn	A65
Vamvax	B81

This list was printed on 22nd November 2017. We sincerely apologise if we have omitted or misplaced any top-quality manufacturers.



Intelligence woven in

Halle 3.0 | C61  
 und Halle 4.2  
[www.drapilux.com](http://www.drapilux.com)



WINDOW  
UPHOLSTERY  
FLOOR

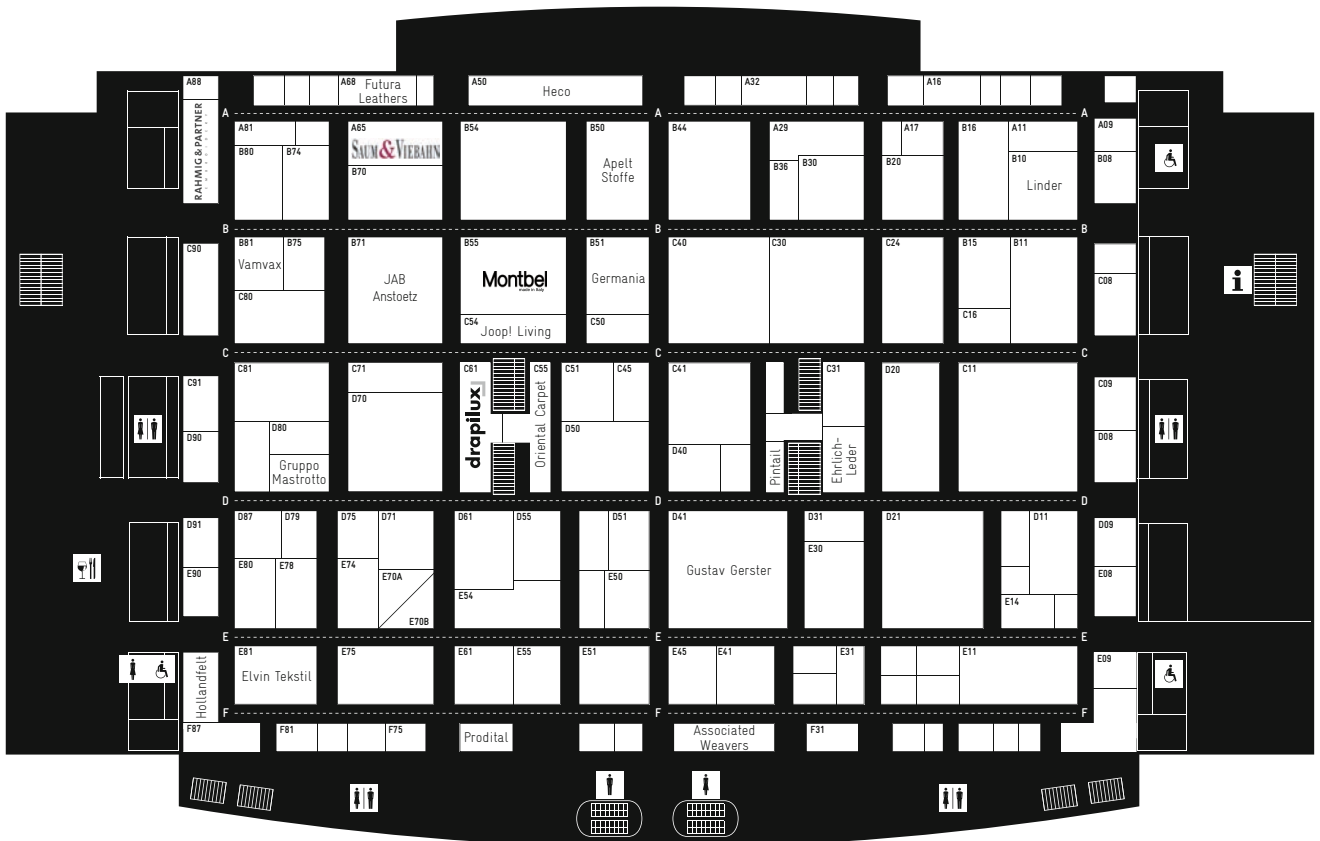

Heimtextil Frankfurt  
Stand B90  
Hall 3.0

**RAHMIG & PARTNER**  
E M B R O I D E R Y

Finest high quality embroidery

Made in Germany

[www.rahmigungpartner.de](http://www.rahmigungpartner.de)



GABRIEL KAKON & SCOTT RICHLER,  
ARCHITECTS + DESIGNERS + FOUNDERS  
GABRIEL SCOTT

»» Architonic speaks to our clientele, which has mostly been trade people. Coming from architecture backgrounds, we speak the same language as Architonic. «

LORENZA LUTI,  
MARKETING & RETAIL DIRECTOR  
KARTELL

»» Architonic is very important for us because it gives us the potential to have direct relations between our company and architects around the world. «

CLAUDIO BELLINI,  
DESIGNER + ARCHITECT

»» Architonic is a very good reference for us as a studio. It is fresh, smart, easy and offers a top selection of quality products. «

JORRE VAN AST,  
CREATIVE DIRECTOR + PRINCIPAL

»» Architonic is a perfect platform for architects to get to know us and contact us, especially outside those markets where we are not so known. «



[interior|fashion]  
more than | furniture

hochwertig  
tiefgründig  
unverzichtbar

[www.interiorfashion.de](http://www.interiorfashion.de)



## Wallcovering Washi.

# ÉLITIS

*Auteur & Éditeur.*